

Kendo XL20 - Installation Instructions

Models KXL20



7777 Merrimac Ave
Niles, IL 60714
T 224.333.6033
F 224.757.7557
info@luminii.com
www.luminii.com



Please read all instructions prior to installation and keep for future reference!

1. Product to be installed by a qualified electrician.
2. Prior to installation ensure power is off at fuse box to prevent electrical shock.
3. Use only with Class 2 power unit. Utiliser seulement avec la classe 2 unite d'alimentation electrique.
4. Type IC, inherently protected, suitable for damp location.
5. Suitable for installation within the closet storage space.

1

1.1 Determine the location of where the fixture will be installed. Lay the fixture on the surface, and make reference marks for the mounting brackets. Make marks 8" from each end of the fixture and one in the center if fixture is over 36".

1.2 Lay the fixed mounting bracket onto the mark points and secure the provided hardware.

2

2.1 Snap fixture into the brackets to secure in place.

2.2 Remove the protective film from the diffuser lens.

2.3 Follow one of the two options to connect the fixture to the power supply.

Option 1- Secure female quick connect to male quick connect. Feed male quick connect wire through conduit to power supply.

OR

Option 2- Feed wire whip to the power supply.

3

3.1 Connect +24 VDC red wire from the fixture to the power supply +24 VDC red wire with a wire nut. Connect -24VDC black wire from the fixture to power supply -24VDC black wire with a wire nut.

Kendo XL20 - Installation Instructions

Models KXL20



7777 Merrimac Ave
Niles, IL 60714
T 224.333.6033
F 224.757.7557
info@luminii.com
www.luminii.com



Please read all instructions prior to installation and keep for future reference!

1. Product to be installed by a qualified electrician.
2. Prior to installation ensure power is off at fuse box to prevent electrical shock.
3. Use only with Class 2 power unit. Utiliser seulement avec la classe 2 unite d'alimentation electrique.
4. Type IC, inherently protected, suitable for damp location.
5. Suitable for installation within the closet storage space.

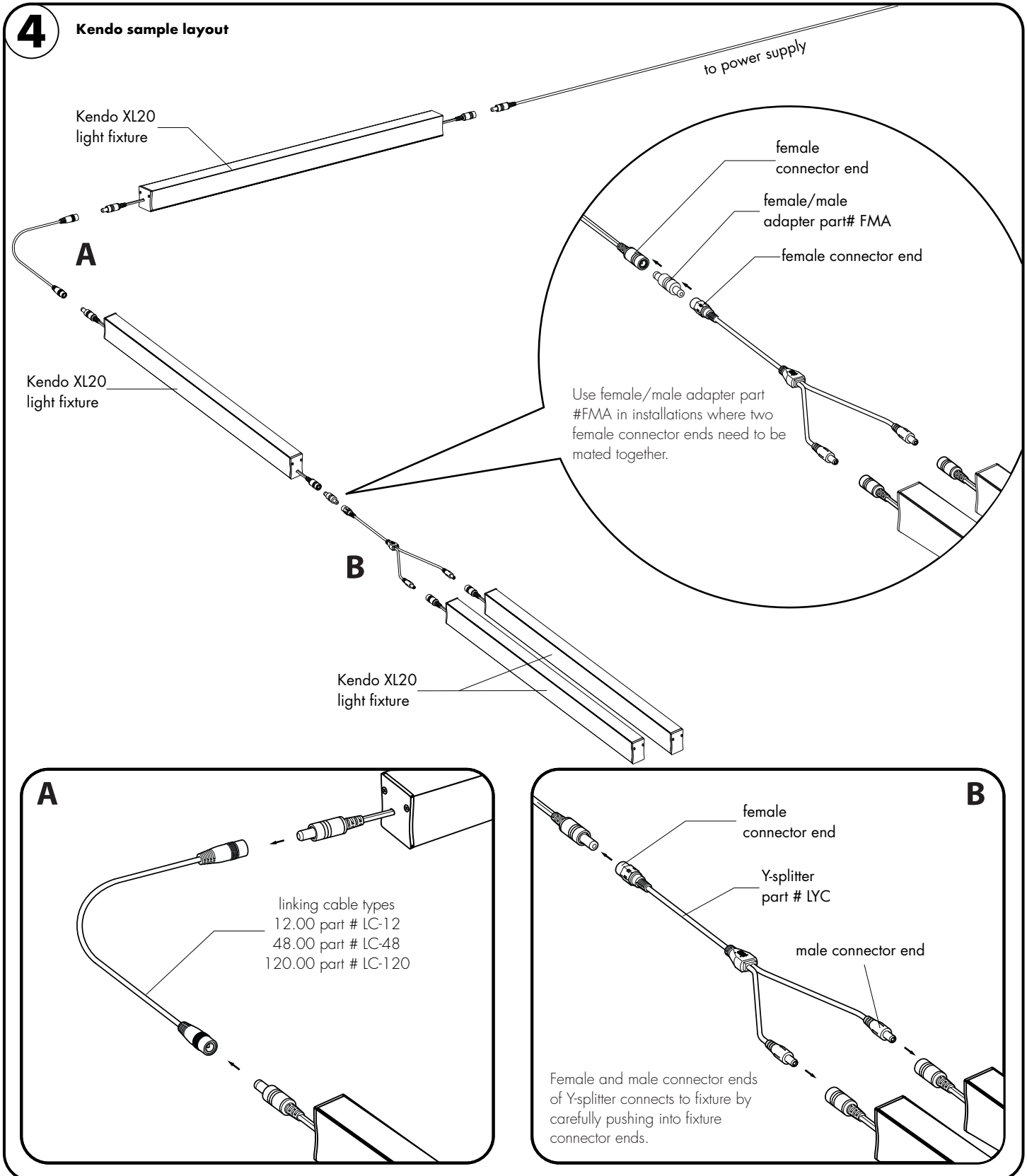

Kendo XL20 - Installation Instructions

Models KXL20



7777 Merrimac Ave
Niles, IL 60714
T 224.333.6033
F 224.757.7557
info@luminii.com
www.luminii.com



Please read all instructions prior to installation and keep for future reference!

1. Product to be installed by a qualified electrician.
2. Prior to installation ensure power is off at fuse box to prevent electrical shock.
3. Use only with Class 2 power unit. Utiliser seulement avec la classe 2 unite d'alimentation électrique.
4. Type IC, inherently protected, suitable for damp location.
5. Suitable for installation within the closet storage space.

multiple powerfeed layouts

power supplies at the end of the run

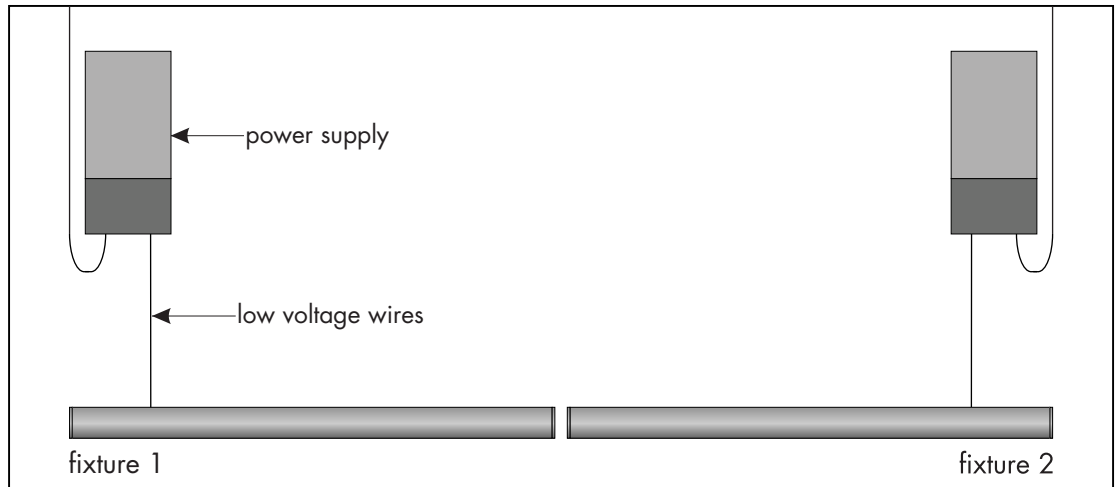

power supplies in the middle of the run

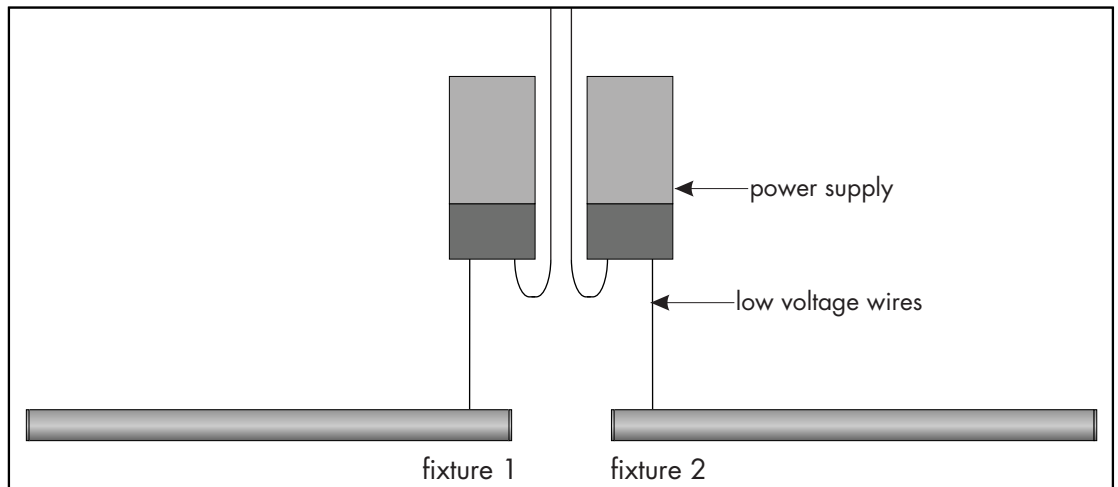

consecutive layout, NOT RECOMMENDED

