

The Cove Channel aluminum extrusion has been designed to fit into a cove applications. Multiple reflector options allow for great flexibility and adaptability for any application. Extrusion is field cuttable. Substantial aluminum mass in profile provides excellent heat sink for high power LEDs.

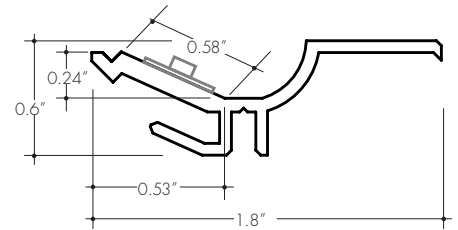
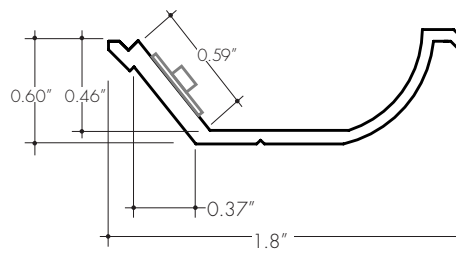

Technical Information

Finish: Silver anodized, with white paint inside

Mounting: screw in

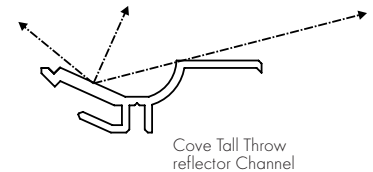
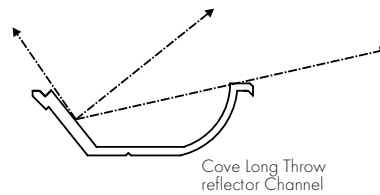

Ordering Code

MODEL	LENGTH	FINISH
CLTC	72	SA
CLTC - Long Throw Reflector CTTC - Tall Throw Reflector	72 - 72" 144 - 144"	SA - Silver anodized

NOTE: For Channels and Lenses over 90", incremental shipping charges will apply

All accessories sold separately.

mCAL Channel Clear Lens

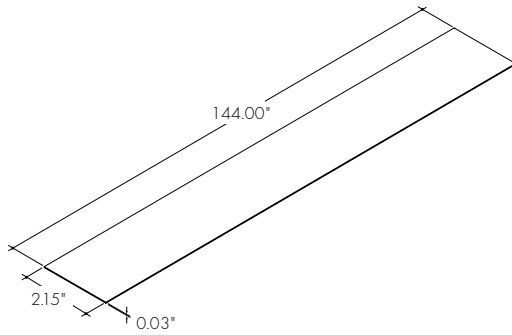

ORDERING CODE

MCAL-C-144

MCAL-C-144 - Clear Lens, 144"

Standard included on MCAL-C order code