

Features

Basics Contractor-Grade Kilo extrusions compatible with Basics LED strips.

Finish

Silver anodized

Mounting

Fixed clip mounting option for quick installation

Diffuser Lens

Polycarbonate, snap-in-place, UV resistant

Product Dimensions

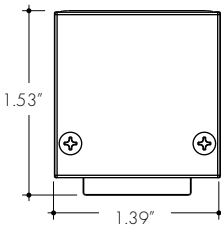
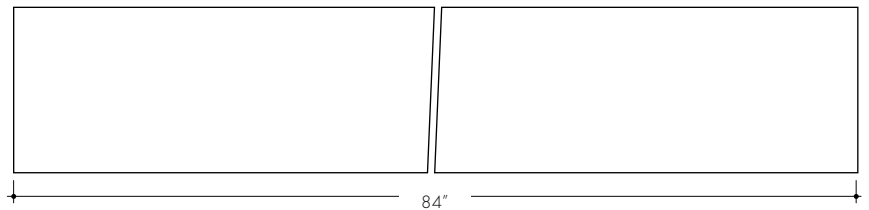
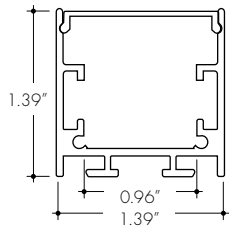

BKC with Fixed Clip

INCLUDED MOUNTING ACCESSORIES

EXTRUSION LENGTH	MOUNTING HARDWARE	END CAP (PAIR)
84"	6	1

Each pair of endcaps includes 1x H0 (no wire feed hole) and 1x H1 (with hole) where applicable. Additional endcaps and mounting clips are available for purchase.

Accessories

All Channels come with a specified set of Mounting Clips and End Caps, see Ordering Code for details. Order additional Mounting Clips and End Caps as necessary.

EC-BKC-H0-SA

Silver Anodized End Cap

EG-BKC-H1-SA

Silver Anodized End Cap with powerfeed opening

MK-BKC-SS

Fixed Clip
-FC

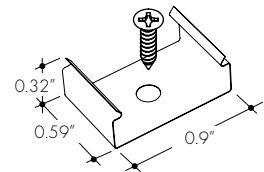
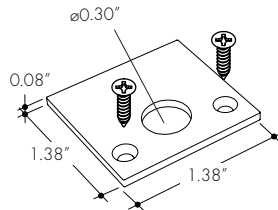
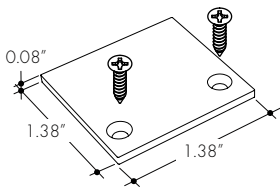

Ordering Code

MODEL	LENGTH	LENS	MOUNTING ²	FINISH
BKC - Basics Kilo Channel ¹	84 - 84"	HF - Half Frosted	FC - Fixed Clip	SA - Silver Anodized

1 - End Caps are included with channel, one of H0 (no hole) and one of H1 (with hole). Order additional End Caps as necessary.

2 - Mounting Clips are included with channel. Refer to chart above for provided mounting clip quantities. Order additional Mounting Clips as necessary.