

Features

Kurba Horizontal RGB & RGBW is a direct view, small profile, energy efficient and flexible LED strip suitable for wet locations capable of horizontal/side bends up to 2.5" radius. Built with robust factory made power feeds or joiners, Kurba Horizontal RGB & RGBW mounts to a specifically designed aluminum extruded channel.

Applications
Outdoor wet location

Approvals
Class 2 wet listed, IP67

Operating Voltage
24VDC

Warranty
3 years

Operating Temperature
-4°F to 113°F (-20°C to 45°C)

Average Life
50,000 hours



Technical Information

Model	KBM-F-H-RGB	KBM-F-H-RGBW
LEDs/ft	18	
Light Output	Red: 6 lm/ft Green: 23 lm/ft Blue: 6 lm/ft All On: 34 lm/ft	Red: 12 lm/ft Green: 37 lm/ft Blue: 8 lm/ft White: 38 lm/ft All On: 95 lm/ft
Average Power Consumption at 4'	3.65 W/ft	4.57 W/ft
Ordering Increment	3.94"	
Maximum Run Length (In Series)	26'	20'

Constraints

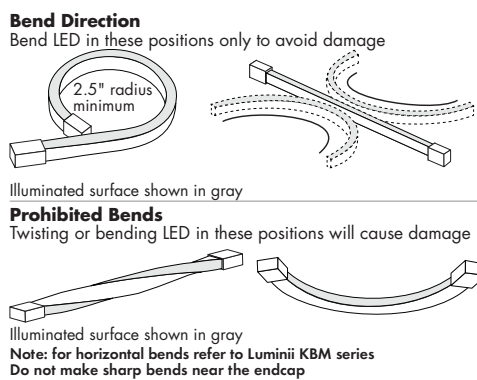

Power Feed Locations

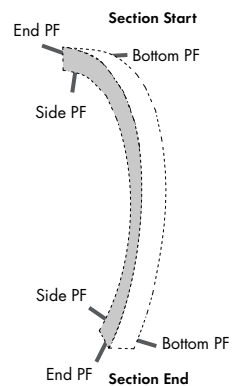

Section Start/End Power Feed Options

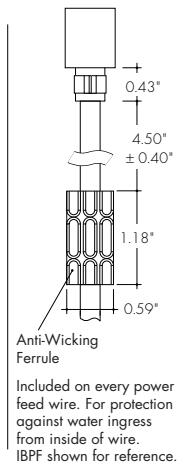
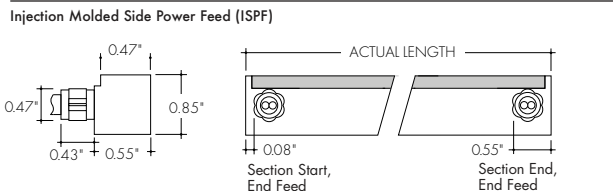
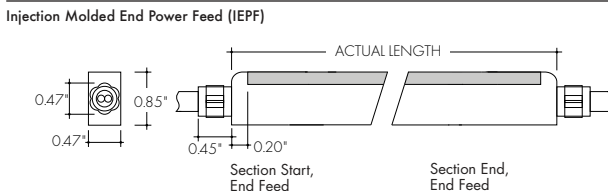
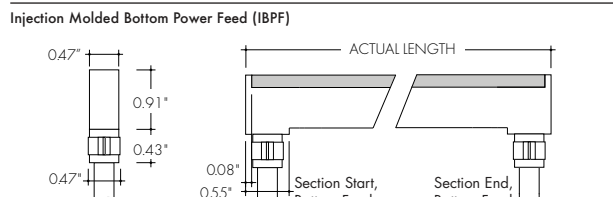
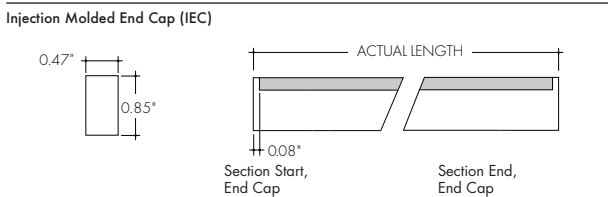

Ordering Code for Straight Run

MODEL	COLOR	SECTION START	SECTION END	ACTUAL LENGTH
KBM-F-H - Kurba Medium, flat horizontal	RGB - Red, Green, Blue RGBW27K - Red, Green, Blue, White (2700K) RGBW30K - Red, Green, Blue, White (3000K) RGBW40K - Red, Green, Blue, White (4000K)	IEC - Injection Molded End Cap ¹ IEPF - Injection Molded End power feed (9' wire lead) ¹ IBPF - Injection Molded Bottom power feed (9' wire lead) ¹ ISPF - Side power feed (9' wire lead) ¹	IEC - Injection Molded End Cap ¹ IEPF - Injection Molded End power feed (9' wire lead) ¹ IBPF - Injection Molded Bottom power feed (9' wire lead) ¹ ISPF - Side power feed (9' wire lead) ¹	See Power Consumption table on page 4 for available lengths

¹ 1 - 6-8 weeks lead time. Kurba injected-molded orders are non-cancellable.

Mounting Accessories & Optional Connectors

MC-NFS-KBM-F-H-78

Mounting Channel with Grip, 78"

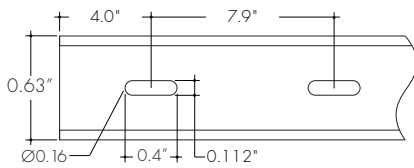
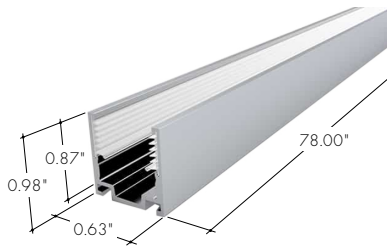

Aluminum mounting channel providing grip. For use with light strip mounted to the ceiling.

MB-KBM-F-H-ST

Mounting Bracket with Grip

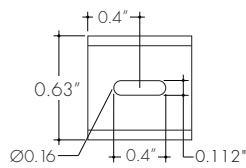
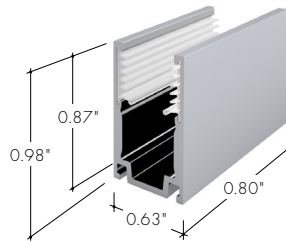

Aluminum mounting bracket providing grip. For use with light strip mounted to the ceiling. 1 recommended every 8 in.

MC-FS-KBM-F-H-78

Flanged Mounting Channel with Grip, 78"

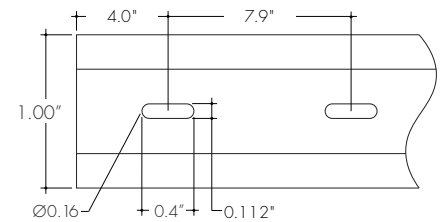
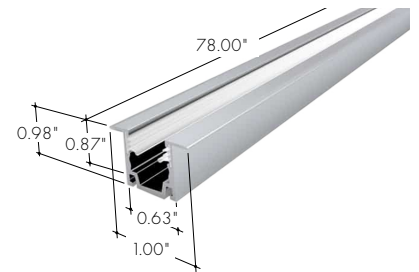

Flanged aluminum mounting channel providing grip. For use with light strip mounted to the ceiling.

MC-BS-KBM-F-H-38

Bendable Mounting Channel with Grip, 38"

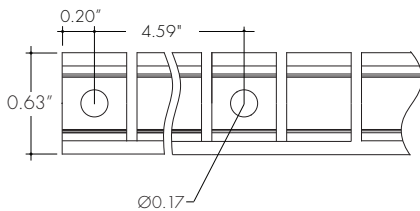
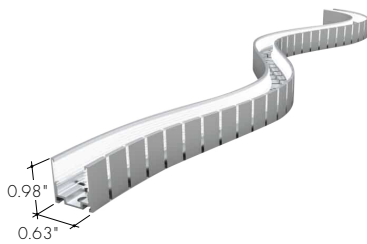

Bendable stainless steel mounting channel providing grip. For use with light strip mounted to the ceiling.

LVSP-WET-CM

Connector

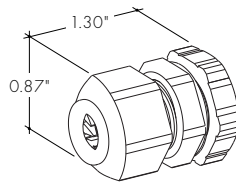

Low voltage splice box wet cable management, gray.

LVSP-WET

Splice Box

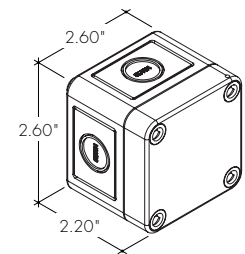

Wet rated, low voltage splice box, gray.

Power Consumption Per Fixture Length

Based on operation with PSD series of power supplies. Use Actual Length for Order Code Entry
 Tolerance for Actual Lengths less than 6 ft is +/- 0.2", Actual Lengths between 6 ft and 16 ft is +/- 0.3", and Actual Lengths greater than 16 ft is +/- 0.6"

KBM-F-H-RGB

Nominal Length (inch)	Actual Length [inches]				Nominal Length (inch)	Actual Length [inches]				Nominal Length (inch)	Actual Length [inches]			
	W	IEPF IEPF	IEC IEPF	IEC IBPF ISPF		W	IEPF IEPF	IEC IEPF	IEC IBPF ISPF		W	IEPF IEPF	IEC IEPF	IEC IBPF ISPF
4	-	-	-	-	138	42.1	138.2	138.1	138	272	82.9	272.1	271.9	271.8
8	2.5	8.3	8.2	8	(12 ft) 143	43.3	142.1	142	141.9	(23 ft) 276	84.1	276	275.9	275.8
(1 ft) 12	3.7	12.2	12.1	12	146	44.5	146.1	145.9	145.8	280	85.3	279.9	279.8	279.7
16	4.9	16.1	16	15.9	150	45.7	150	149.9	149.8	284	86.5	283.9	283.7	283.6
20	6.1	20.1	20	19.8	(13 ft) 154	46.9	153.9	153.8	153.7	(24 ft) 288	87.7	287.8	287.7	287.6
(2 ft) 24	7.3	24	23.9	23.8	158	48.1	157.9	157.8	157.6	292	88.9	291.7	291.6	291.5
28	8.5	28	27.8	27.7	162	49.3	161.8	161.7	161.6	296	90.1	295.7	295.6	295.4
32	9.7	31.9	31.8	31.7	166	50.5	165.8	165.6	165.5	(25 ft) 300	91.3	299.6	299.5	299.4
(3 ft) 36	10.9	35.8	35.7	35.6	(14 ft) 170	51.7	169.7	169.6	169.5	304	92.5	303.5	303.4	303.3
40	12.1	39.8	39.7	39.5	174	52.9	173.6	173.5	173.4	308	93.7	307.5	307.4	307.2
44	13.3	43.7	43.6	43.5	178	54.1	177.6	177.4	177.3	(26 ft) 312	94.9	311.4	311.3	311.2
(4 ft) 48	14.5	47.6	47.5	47.4	(15 ft) 182	55.3	181.5	181.4	181.3					
52	15.7	51.6	51.5	51.3	186	56.5	185.4	185.3	185.2					
56	16.9	55.5	55.4	55.3	190	57.7	189.4	189.3	189.1					
(5 ft) 60	18.1	59.5	59.3	59.2	(16 ft) 193	58.9	193.3	193.2	193.1					
63	19.3	63.4	63.3	63.2	197	60.1	197.3	197.1	197					
67	20.5	67.3	67.2	67.1	201	61.3	201.2	201.1	200.9					
(6 ft) 71	21.7	71.3	71.1	71	(17 ft) 205	62.5	205.1	205	204.9					
75	22.9	75.2	75.1	75	209	63.7	209.1	208.9	208.8					
79	24.1	79.1	79	78.9	213	64.9	213	212.9	212.8					
(7 ft) 83	25.3	83.1	83	82.8	(18 ft) 217	66.1	216.9	216.8	216.7					
87	26.5	87	86.9	86.8	221	67.3	220.9	220.8	220.6					
91	27.7	91	90.8	90.7	225	68.5	224.8	224.7	224.6					
(8 ft) 95	28.9	94.9	94.8	94.6	(19 ft) 229	69.7	228.7	228.6	228.5					
99	30.1	98.8	98.7	98.6	233	70.9	232.7	232.6	232.4					
103	31.3	102.8	102.6	102.5	237	72.1	236.6	236.5	236.4					
(9 ft) 107	32.5	106.7	106.6	106.5	(20 ft) 241	73.3	240.6	240.4	240.3					
111	33.7	110.6	110.5	110.4	245	74.5	244.5	244.4	244.3					
115	34.9	114.6	114.5	114.3	249	75.7	248.4	248.3	248.2					
(10 ft) 119	36.1	118.5	118.4	118.3	(21 ft) 253	76.9	252.4	252.2	252.1					
123	37.3	122.4	122.3	122.2	257	78.1	256.3	256.2	256.1					
126	38.5	126.4	126.3	126.1	260	79.3	260.2	260.1	260					
(11 ft) 130	39.7	130.3	130.2	130.1	(22 ft) 264	80.5	264.2	264.1	263.9					
134	40.9	134.3	134.1	134	268	81.7	268.1	268	267.9					

Note: all values are rounded to the nearest 0.1 inch

End Cap (IEC)

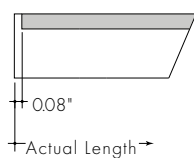

Bottom Power Feed (IBPF)

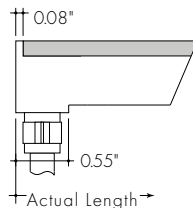

Side Power Feed (ISPF)

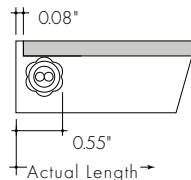

End Power Feed (IEPF)

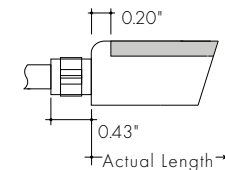

Power Consumption Per Fixture Length

Based on operation with PSD series of power supplies. Use Actual Length for Order Code Entry

KBM-F-H-RGBW (27K, 30K, 40K)

Nominal Length (inch)	W	Actual Length [inches]			Nominal Length (inches)	W	Actual Length [inches]		
		IEPF IEPF	IEC IEPF	IEC IBPF ISPF			IEPF IEPF	IEC IEPF	IEC IBPF ISPF
4	—	—	—	—	126	48.2	126.4	126.3	126.1
8	3.2	8.3	8.2	8	(11 ft) 130	49.7	130.3	130.2	130.1
(1 ft) 12	4.7	12.2	12.1	12	134	51.2	134.3	134.1	134
16	6.2	16.1	16	15.9	138	52.7	138.2	138.1	138
20	7.7	20.1	20	19.8	(12 ft) 143	54.2	142.1	142	141.9
(2 ft) 24	9.2	24	23.9	23.8	146	55.7	146.1	145.9	145.8
28	10.7	28	27.8	27.7	150	57.2	150	149.9	149.8
32	12.2	31.9	31.8	31.7	(13 ft) 154	58.7	153.9	153.8	153.7
(3 ft) 36	13.7	35.8	35.7	35.6	158	60.2	157.9	157.8	157.6
40	15.2	39.8	39.7	39.5	162	61.7	161.8	161.7	161.6
44	16.7	43.7	43.6	43.5	166	63.2	165.8	165.6	165.5
(4 ft) 48	18.2	47.6	47.5	47.4	(14 ft) 170	64.7	169.7	169.6	169.5
52	19.7	51.6	51.5	51.3	174	66.2	173.6	173.5	173.4
56	21.2	55.5	55.4	55.3	178	67.7	177.6	177.4	177.3
(5 ft) 60	22.7	59.5	59.3	59.2	(15 ft) 182	69.2	181.5	181.4	181.3
63	24.2	63.4	63.3	63.2	186	70.7	185.4	185.3	185.2
67	25.7	67.3	67.2	67.1	190	72.2	189.4	189.3	189.1
(6 ft) 71	27.2	71.3	71.1	71	(16 ft) 193	73.7	193.3	193.2	193.1
75	28.7	75.2	75.1	75	197	75.2	197.3	197.1	197
79	30.2	79.1	79	78.9	201	76.7	201.2	201.1	200.9
(7 ft) 83	31.7	83.1	83	82.8	(17 ft) 205	78.2	205.1	205	204.9
87	33.2	87	86.9	86.8	209	79.7	209.1	208.9	208.8
91	34.7	91	90.8	90.7	213	81.2	213	212.9	212.8
(8 ft) 95	36.2	94.9	94.8	94.6	(18 ft) 217	82.7	216.9	216.8	216.7
99	37.7	98.8	98.7	98.6	221	84.2	220.9	220.8	220.6
103	39.2	102.8	102.6	102.5	225	85.7	224.8	224.7	224.6
(9 ft) 107	40.7	106.7	106.6	106.5	(19 ft) 229	87.2	228.7	228.6	228.5
111	42.2	110.6	110.5	110.4	233	88.7	232.7	232.6	232.4
115	43.7	114.6	114.5	114.3	237	90.2	236.6	236.5	236.4
(10 ft) 119	45.2	118.5	118.4	118.3	(20 ft) 241	91.7	240.6	240.4	240.3
123	46.7	122.4	122.3	122.2					

Note: all values are rounded to the nearest 0.1 inch

Injection Molded
End Cap (IEC)

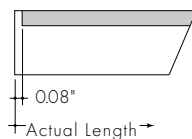

Injection Molded
Bottom Power Feed (IBPF)

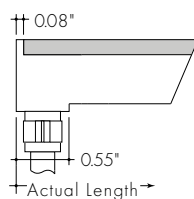

Injection Molded
Side Power Feed (ISPF)

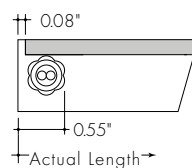

Injection Molded
End Power Feed (IEPF)

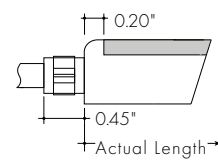

Power Supplies

See fixture and power supply instructions & spec sheet for wiring information. Dimming possible in select models - view Luminii website for list of compatible dimmers.

For use with RGB/RGBW

Non-Dimming Power Supply 120VAC - 277VAC

MODEL	POWER	OUTPUT	DIMMING	LOCATION
PSV - PSV Series	96 - 96 Watt	24 - 24 VDC	U2ND - Non Dimming	D - Dry location

Requires a controller and a decoder to work properly

MODELS	96W
A Length	14.40"
B Width	5.20"
Depth	2.60"

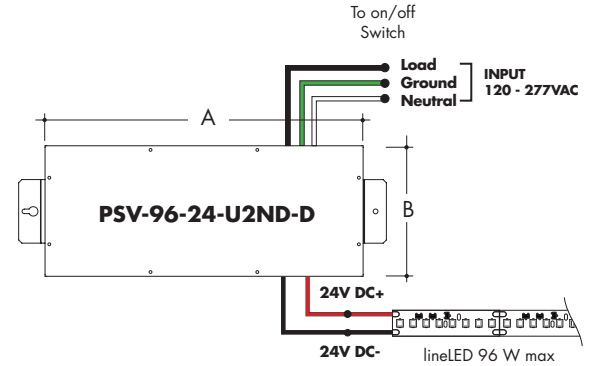

For use with RGB/RGBW

DMX 0% Dimming Power Supplies 120VAC - 277VAC

MODEL	POWER	OUTPUT
PSDMX-DMX Power Supply dims down to 0%	96 - 96 Watt 3X96 - 3 X 96 Watt	24-24 VDC

Features eldoLED's LINEARdrive configurable dimmable drivers.

DDMX-RGBW DMX Decoder not required when purchasing this power supply.

MODELS	96W	3X96
A Length	14.40"	15.75"
B Width	5.20"	6.62"
Depth	2.60"	4.95"

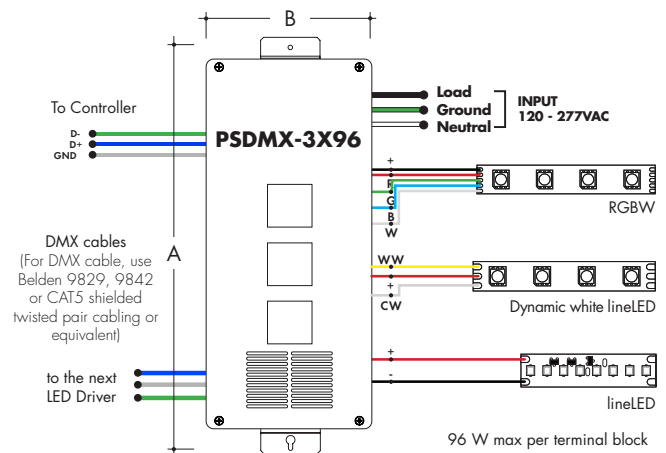
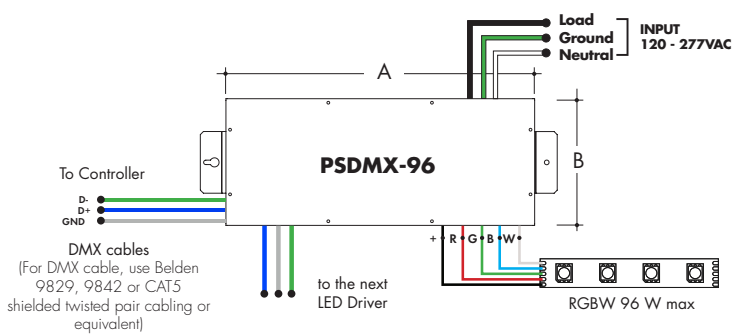

DMX-1Z-RGBW, DMX-3Z-RGBW

RGBW LED 1 or 3 Zone Controller

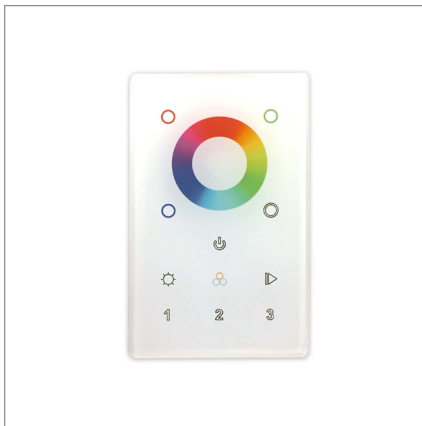

DMX /Wireless RGB-W wall-mount controller controls DMX lighting fixtures, wireless control of RGB-W lighting fixture or use both simultaneously. Fits in any standard US switch box. Includes all the outputs in the back of the controller.

Control brightness levels with a single touch, personalize and memorize 3 different scenes, and even create 3 variations of white.

Features

- 2 in 1 in-Wall Controller: DMX Control or Wireless RGB-W
- 65,000 Color Options, Dimming and Speed Control
- Memory Function
- 50 Foot Wireless Range
- Easily Fits Standard US Switch Boxes
- Touch Sensitive Glass Surface
- Includes 10 Built in Programs, or Create and Play Your Own

Operating Voltage

12 - 24V DC

Color Parameters

- Brightness
- Saturation
- Primary colors
- Fading
- Color changing speed

ORDERING CODE

MODEL	ZONES	COLOR
DMX - DMX Controller	3Z - Three Zone 1Z - One Zone	RGBW - Red, Green, Blue, & White

Touch DMX Controller

Touchscreen digital LED controller

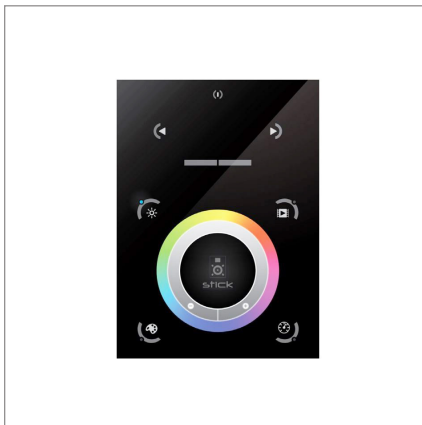

Programmable advanced DMX512 lighting controller featuring a touch-screen interface. Operates as stand alone controller or integrated with most architectural lighting control systems. Can controller endless DMX512 enabled devices.

Mounts to standard single or dual gang wall box with the included power supply inside the junction box. Terminal block design for power and data connections.

Features

- Sleek glass design which sits 0.43" from the wall
- Graphical color display to show selected environment
- Color/dimmer/speed palette
- Color temperature mixing
- Touch sensitive buttons. No mechanical parts
- Touch sensitive wheel allows for accurate color selection
- Multi-zone microSD memory
- Multi-room control with 500 scenes, 10 zones
- 1024 DMX channels. Control 340 RGB fixtures
- USB & Ethernet connectivity for programming and control

Power Supply

7 VDC (included)

Programmability

PC, Mac, Tablet, Smartphone

Output Signal

DMX512 (1024 channels)

Color Parameters

- Brightness
- Saturation
- Speed of color changing sequence
- Fading / dimming / brightness

ORDERING CODE

MODEL
TSDMX-E

TSDMX-E - Touchscreen DMX controller

