

**Features**

- Recessed track supports Stenos directional and ambient modules
- Minimalist and narrow track seamlessly integrates into environments
- Two channel track allows independent dim control for groups of modules when paired with appropriate power supplies
- Snap-in Electrical Joiners include magnetic black/white Cover Plates to maintain clean aesthetic.
- Custom drawing and approval is required for every STENOS Track System prior to order acceptance.
- 24 VDC Class 2 power supply
- 4A max on track
- 96W max on track per power supply
- For ceiling thicknesses from 0.375" up to 1.25"
- Dry location only



**Finish Options**

- Black powder coated
- White powder coated

**Product Dimensions**

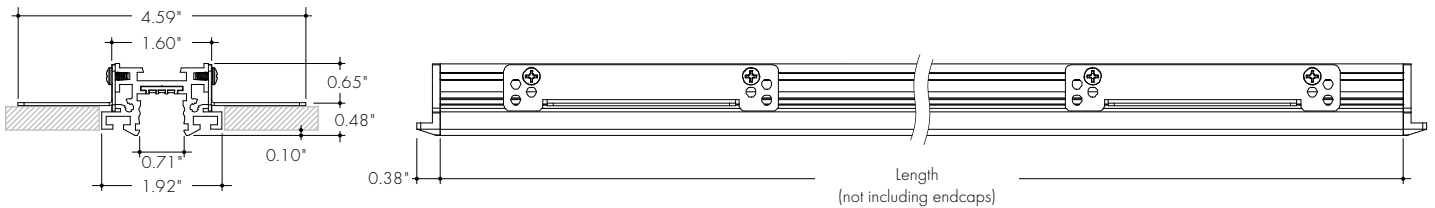

Straight Run

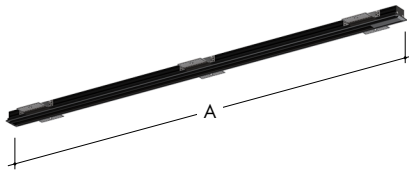

L Shape



U Shape

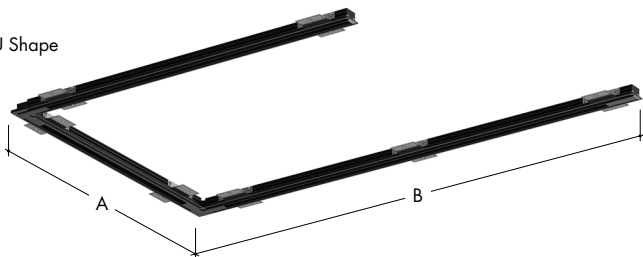

Rectangle Shape

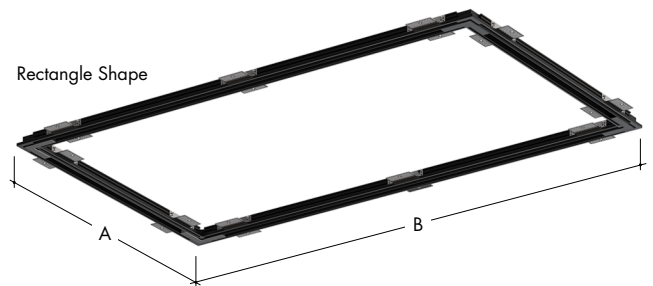

**Ordering Code**

example: STL-R-40-BK-UNV-240-C-XXXXXX

MODEL <sup>1</sup>	SHAPE	OVERALL LENGTH <sup>2</sup>	FINISH	POWER SUPPLY <sup>3</sup>	WATTAGE	SERIAL NUMBER
STL-Stenos Recessed Trimless Track	S-Straight Run R-Rectangle Shape L-L Shape U-U Shape	- Overall run length of system/shape (rounded up to the nearest foot)	BK-Black WH-White	ND-NonDim, PSVND UNV-Phase and 0-10V, 1%, PDCU 010V-LIN-0-10V Linear, 0.1%, PS010V-LIN 010V-LOG-0-10V Logarithmic, 0.1%, PS010V-LOG 010V-LIN-AWNR-0-10V Linear, 0.1%, PS010V-LIN-AWNR 010V-LOG-AWNR-0-10V Linear, 0.1%, PS010V-LOG-AWNR DALI-DALI, 0.1%, PSDALI DMX-DMX, 0.1%, PSDMX LUTES-Lutron EcoSystem, 1%, L3D LUT2W-Lutron HiLume 2-wire Phase, 1%, LTE (120 VAC only) 2CH010V-2 Channel 0-10V, 0.1%, PS010VD-W2I 2CHDMX-2 Channel DMX, 0.1%, PSDMX 2CH010V-AWNR-2 Channel 0-10V with Lutron Athena, 0.1%, PS010V-2CH-AWNR	-Watts (rounded up to the nearest Watt, see Wattage Calculation Guide, next page)	Serial Number, entered by Luminii

1-Custom drawing and approval is required for every STENOS Track System prior to order acceptance. Allow 2 weeks (typical) for custom drawing generation/confirmation process. Use STENOS Track System Sketch Grid to convey as many details as possible including: shape, dimension of each leg, desired location of power feeds, and location of track modules (Directional, Ambient, Track Heads).  
2-Mechanical joiners are required for sections longer than 12ft.  
3-Power supplies are 120-277 VAC input, unless otherwise noted.

Product Dimensions

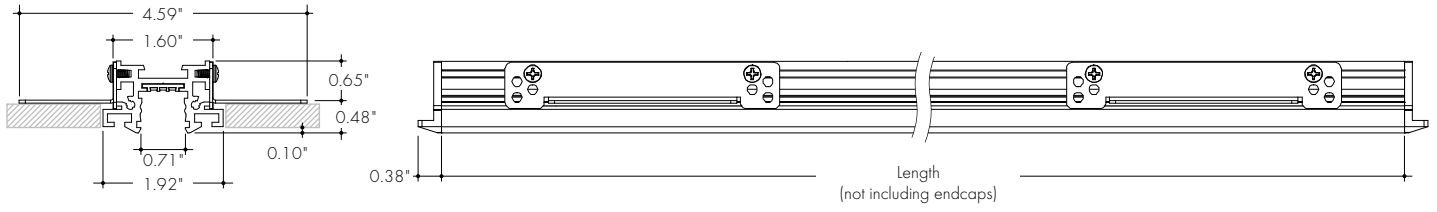

Stenos Track with Directional Module and Louver

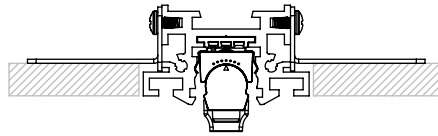
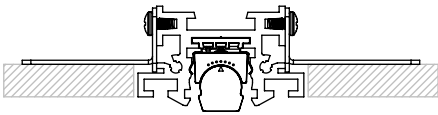

Stenos Track with Ambient Module and Louver

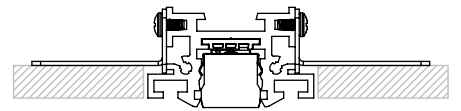

Wattage Calculation Guide

Stenos Track Module	Wattage	Lumens (3000K)	Length	Reference
<b>STENOS 3" Directional Module</b>	2.6 W	250 lm	2.5 in	
<b>STENOS 5" Directional Module &amp; STENOS 5" Wall Wash Module</b>	5.4 W	520 lm 275 lm	4.8 in	
<b>STENOS 12" Directional Module &amp; STENOS 12" Wall Wash Module</b>	13.0 W	1260 lm 665 lm	11.8 in	
<b>STENOS 1" Track Head Long</b> 15° optic Regressed Baffle <b>STENOS 1" Track Head Short</b> 15° optic Regressed Baffle	6.6 W 5.2 W	565 lm 458 lm	4.9 in	
<b>STENOS 24" Ambient Module SO</b>	5.5 W	475 lm	24.4 in	
<b>STENOS 24" Ambient Module HO</b>	12.3 W	1000lm	24.4 in	
<b>STENOS 48" Ambient Module SO</b>	11.0 W	950 lm	48.0 in	
<b>STENOS 48" Ambient Module HO</b>	24.7 W	2025 lm	48.0 in	

Wattage Calculation Guide (Example)

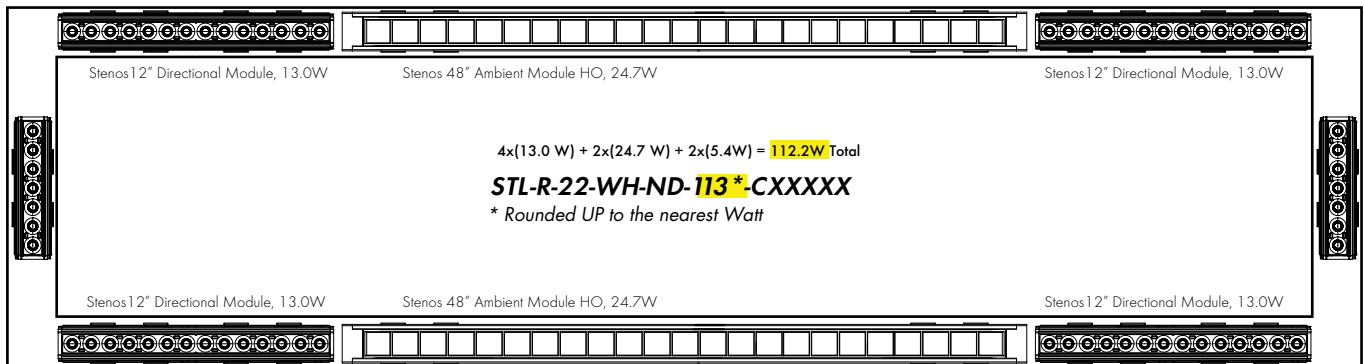

Factory Built Sections

Straight Run

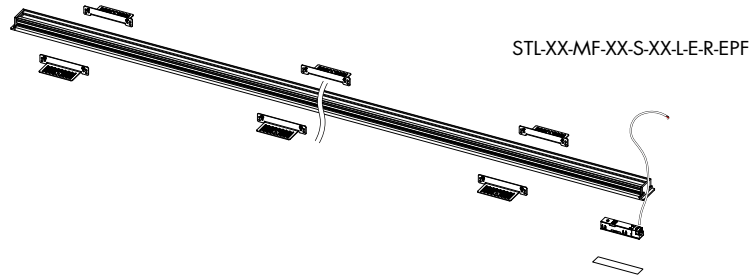

L Shape

STL-XX-MF-XX-L-XX-L-E-R-CHL

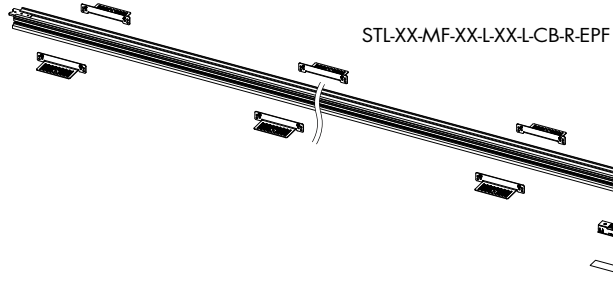
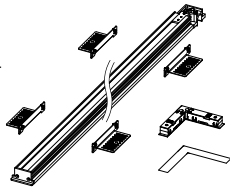

U Shape

STL-XX-MF-XX-U-XX-L-CB-R-CHL

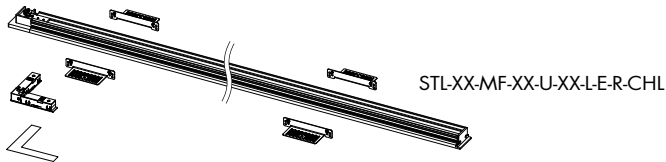
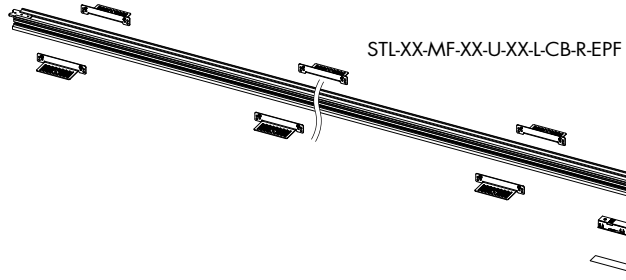
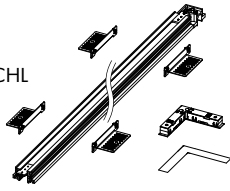

Rectangle Shape

STL-XX-MF-XX-R-XX-L-CB-R-CHL

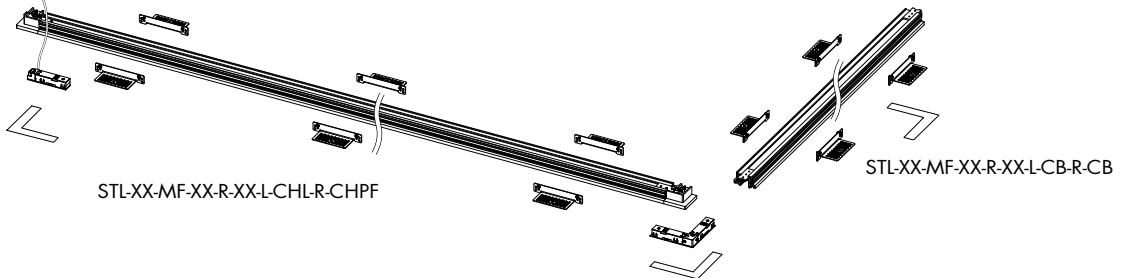
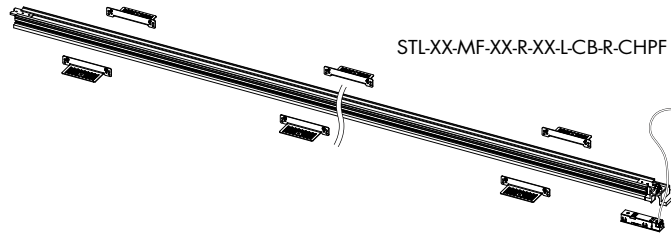
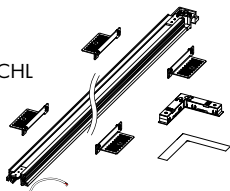

**Power Supplies**

See Power Supply instructions and spec sheet for wiring information. For a complete list of compatible dimmers, see Compatible Dimming Chart on the Resources page.

**Single Channel Control**

**-ND**  
Non-Dimming, 120-277VAC, PSV-ND-D

MODELS	96W
Length	14.40"
Width	5.20"
Depth	2.60"

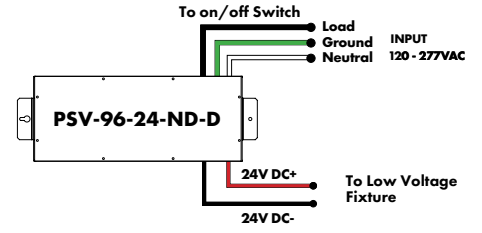

**-UNV**  
Universal, Phase (MLV/ELV/Triac) and 0-10V, 1% 120-277VAC, PDCU-W

MODELS	96W
Length	8.66"
Width	3.73"
Depth	1.61"

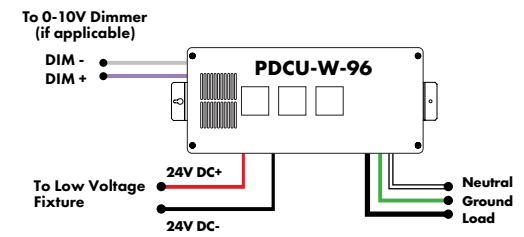

**-010V-LIN/LOG**  
0-10V, 0.1% Linear/Logarithmic, 120 - 277VAC, PS010V

MODELS	96W
Length	14.40"
Width	5.20"
Depth	2.60"

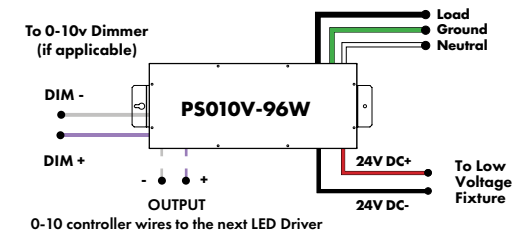

**-DALI**  
DALI, 0.0%, 120 - 277VAC, PSDALI

Model	96W
Length	14.40"
Width	5.20"
Depth	2.60"

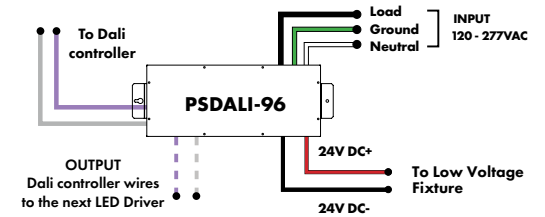

**-DMX**  
DMX, 0.0%, 120 - 277VAC, PSDMX

MODELS	96W
Length	14.40"
Width	5.20"
Depth	2.60"

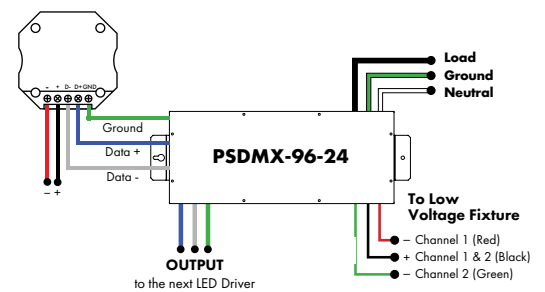

**Power Supplies**

See Power Supply instructions and spec sheet for wiring information. For a complete list of compatible dimmers, see Compatible Dimming Chart on the Resources page.

**Two Channel Control**

**-2CH010V**

2 CHANNEL 0-10V, 0.1% LINEAR, 120-277VAC, PS010WD-W2I

MODELS	96W
Length	14.40"
Width	5.20"
Depth	2.60"

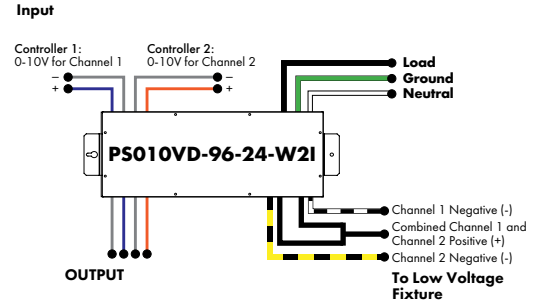

**-2CHDMX**

2 CHANNEL DMX, 0.0%, 120-277VAC, PSDMX

MODELS	96W
Length	14.40"
Width	5.20"
Depth	2.60"

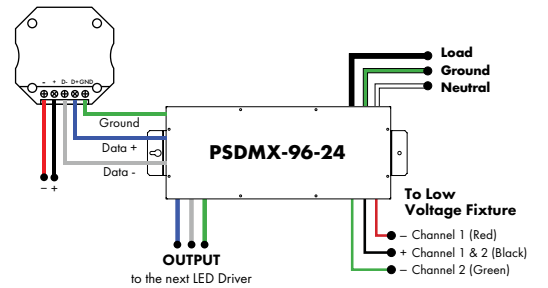

**Track Components (for field configurable systems)**

To minimize voltage drop, it is recommended to not exceed 24ft of track per power feed or 3 track joiners per power feed.

**EC-STL-H3-XX**  
Recessed Trimless End Caps

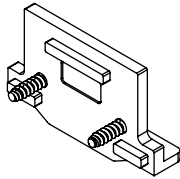

Blank End Cap for ending a Recessed Trimless run

**JOIN-M-ST**  
Mechanical Joiner Brackets

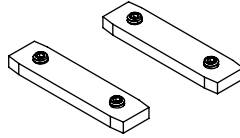

Used for mechanically joining adjacent Track sections

**TC-96-XX**  
Track Cover, 96"

**TC-144-XX**  
Track Cover, 144"

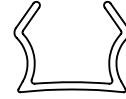

Track Covers ship complete with Recessed Trimless Track and cover unoccupied sections of track. They are field cuttable and can be used to protect channel during the mudding process. Additional can be ordered, if necessary.

**JOIN-M-L-STL-XX**  
Recessed Trimless Mechanical L Joiner

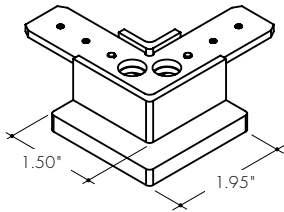

For creating a 90deg in-plane corner

**JOIN-M-W-STL-XX**  
Recessed Trimless Mechanical Wall to Ceiling Joiner

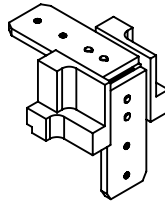

For creating a 90deg Wall to Ceiling corner

**MB-STL**  
Mounting Bracket, Hanger Bar or Threaded Rod

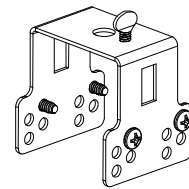

Hanger bars ordered separately. Threaded rod and nuts not included

**STL-48/96/144-MF/MB-XX**  
StenosTrimless Track, Recessed

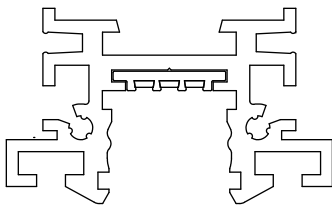

**PF-HB-ALL**  
Hanger Bars for use with MB-STL Mounting Bracket

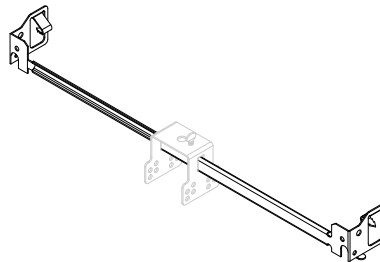

For use to mount to joists. MB-STL not included.

XX	Color
WH	White
BK	Black

**Track Components**

To minimize voltage drop, it is recommended to not exceed 24ft of track per power feed or 3 track joiners per power feed.

**ST-JOIN-E-P**

Electrical Power Feed, with black and white Cover Plates

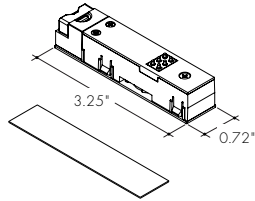

For use with 18AWG field wires with max outer diameter 0.3" (cable and power feed do not ship pre-assembled)

**ST-JOIN-E-P-72**

Electrical Power Feed, 72" Plenum Cable

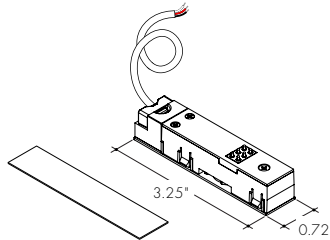

with Black and White cover plates (cable and power feed do not ship pre-assembled)

**ST-JOIN-E-S**

Electrical Joiner, Straight, with black and white Cover Plates

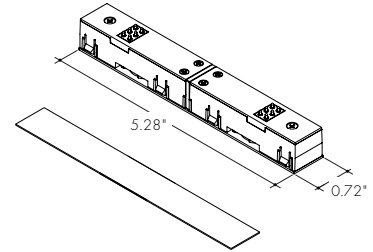

For electrically joining adjacent Track sections

**ST-JOIN-E-L**

Electrical Joiner, L with black and white Cover Plates

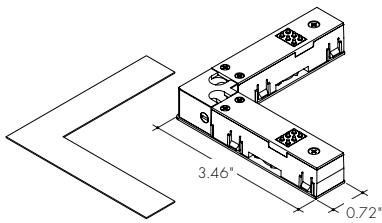

For for use with Mechanical L Joiner

**ST-JOIN-E-F**

Electrical Joiner, Flexible with black and white Cover Plates

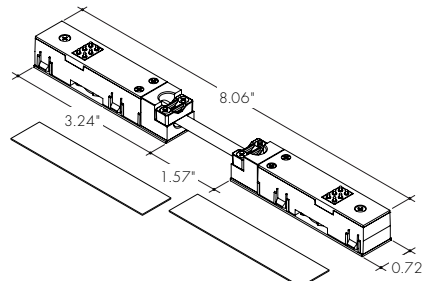

For use with Mechanical L Joiner or Wall to Ceiling Joiner

**Wiring and Multiple Channels**

For **single channel** use, connect black and white power feed wires.

For **two channel** use, connect per wiring diagram in the Two Channel Control section of power supplies

For **Dynamic White** use, connect per wiring diagram in the Dynamic White section of power supplies

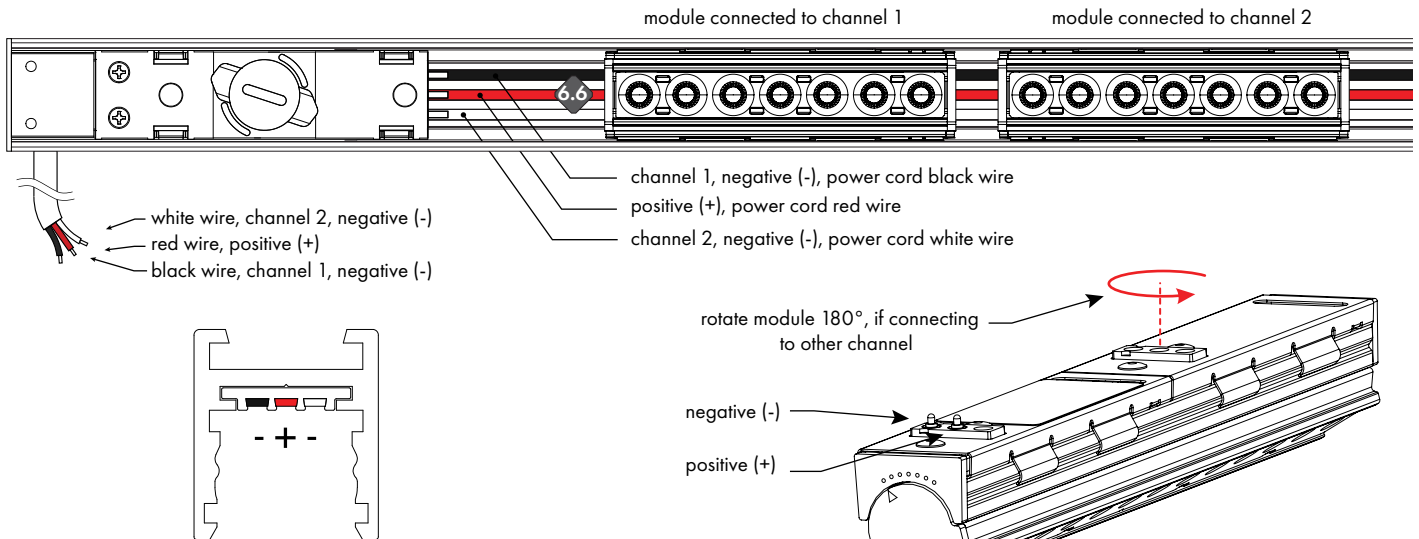

The Power Track contains three copper conductors allowing two channel control .

- Center conductor is common positive (+), connected to power cord red wire
- One outer conductor is channel 1 negative (-), connected to power cord black wire
- Other outer conductor is channel 2 negative (-), connected to power cord white wire

Select control channel for Stenos Directional and Ambient Modules by rotating them 180°

For **two channels** use, connect per wiring diagram in the Two Channel Control section of power supplies

For **single channel** use, connect black and white power feed wires.

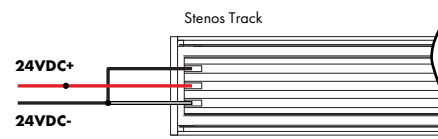

For single channel use, connect black and white wires



**STENOS Track System Sketch Grid**

Use grid below to sketch out details of the STENOS Track System. Include as many details as possible such as:

- Shape
- Dimensions of each leg
- Location of Power Feeds
- Location and Type of Track Modules (Directional, Ambient, Track Heads)
- Ceiling Thickness (for Trimless Tracks)

**Note:** 96W max, 24ft max,  
and 3 electrical joiners max  
per power feed  
See example on next page

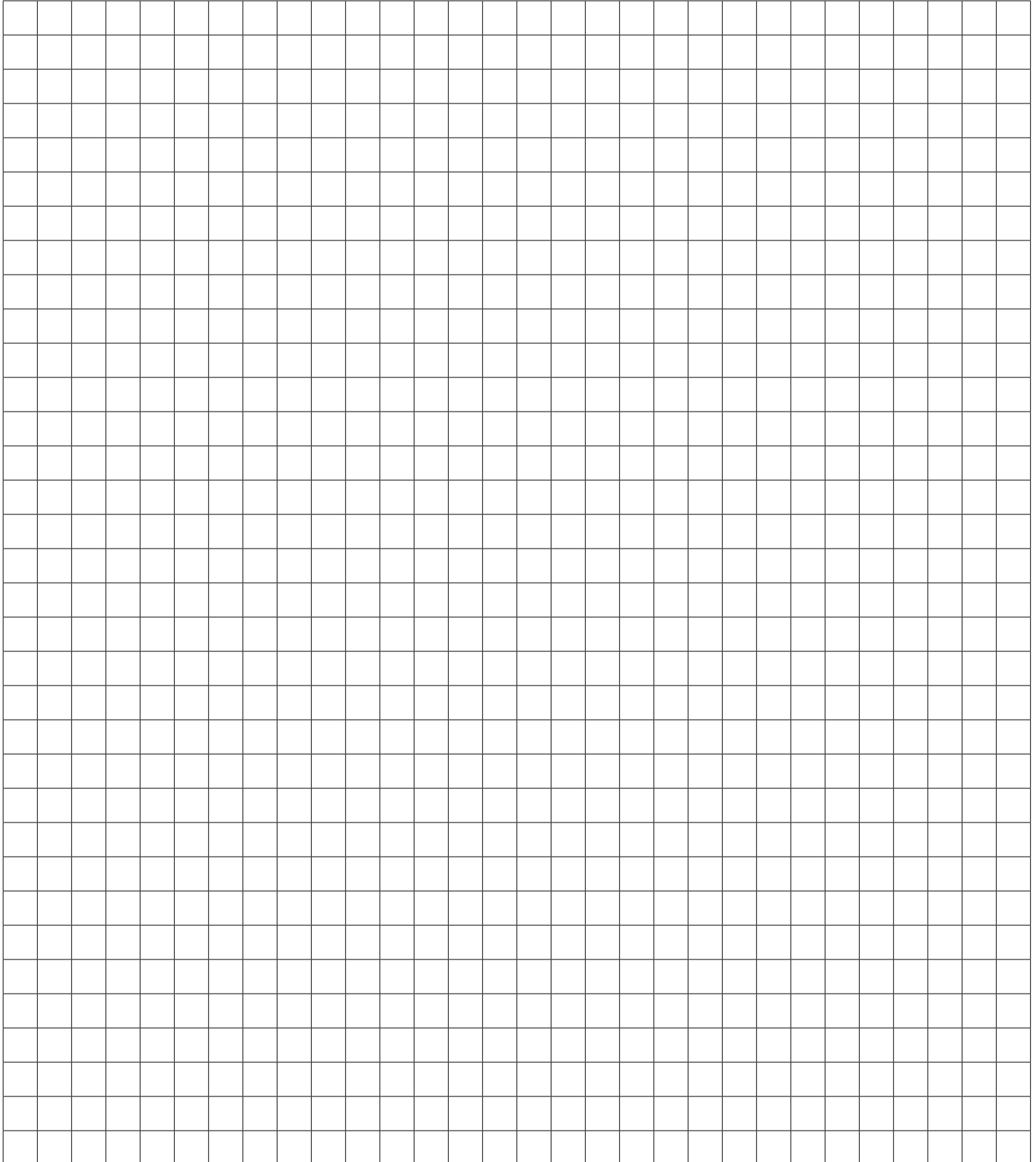

**STENOS Track System Sketch Grid (Example)**

Use grid below to sketch out details of the STENOS Track System. Include as many details as possible such as:

- Shape
- Dimensions of each leg
- Location of Power Feeds
- Location and Type of Track Modules (Directional, Ambient, Track Heads)
- Ceiling Thickness (for Trimless Tracks)

**Note:** 96W max, 24ft max, and 3 electrical joiners max per power feed

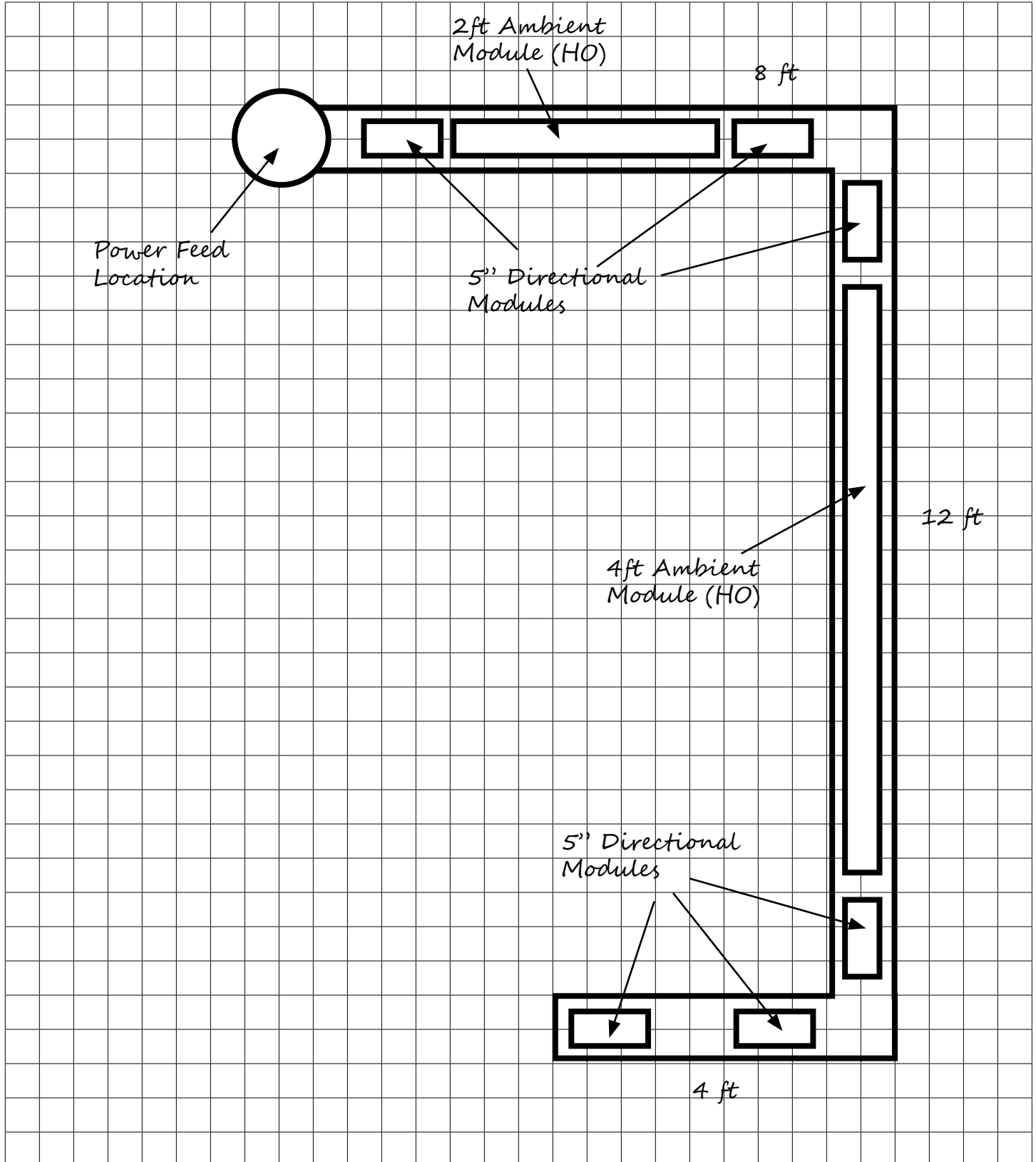

Additional Stenos Products



(left to right)  
Stenos Recessed Deep Trimless Track  
Stenos Recessed Trimless Track  
Stenos Recessed Trimmed Track  
Stenos Surface Mount Track  
Stenos Suspended Track



Stenos Directional Module

Stenos Directional Module with Louver

Stenos Directional Module with Wall Wash

Stenos Ambient Module

Stenos Ambient Module with Louver

