

Features

Kurba Small Vertical is a direct view, small profile, energy efficient and flexible LED strip suitable for wet locations capable of vertical/top bends up to 2" radius. Built with robust factory made power feeds or joiners, Kurba Small Vertical mounts to a specifically designed aluminum extruded channel.

Applications

Outdoor wet location

Operating Voltage

24VDC

Operating Temperature

-4°F to 113°F (-20°C to 45°C)

Average Life

50,000 hours

Dimming

Low voltage dimmer and class 2 dimming power supply required

Approvals

Class 2 wet listed, IP65

Warranty

3 years



Technical Information

Model	KBS	CCT INFO / LUMEN MULTIPLIER	
		Color Temperature	Multiplier (ref. -3000K)
LEDs/ft	43	2200K	0.98
Light Output at 3000K	58 lm/ft	2400K	1.00
Average Power Consumption at 4'	1.4 W/ft	2700K	1.01
Ordering Increment	3.28"	3000K	1.00
Maximum Run Length (In Series)	30 ft	3500K	1.08
		4000K	1.04

Constraints

Bend Direction

Bend LED in these positions only to avoid damage

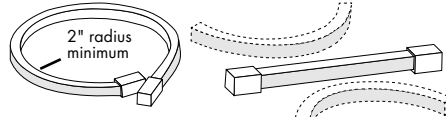

Illuminated surface shown in gray

Prohibited Bends

Twisting or bending LED in these positions will cause damage

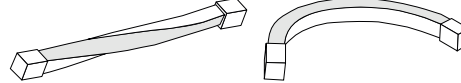

Illuminated surface shown in gray

Note: for horizontal bends refer to Luminii KBM series
Do not make sharp bends near the endcap

Power Feed Locations

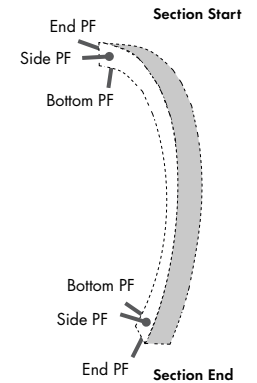

Section Start/End Power Feed Options

Injection Molded End Cap (IEC)

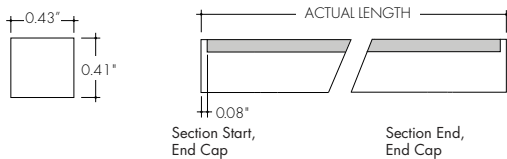

Injection Molded Bottom Power Feed (IBPF)

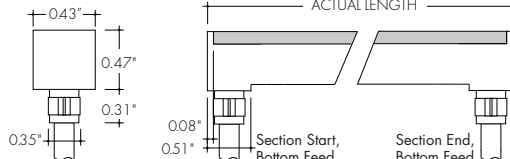

Injection Molded End Power Feed (IEPF)

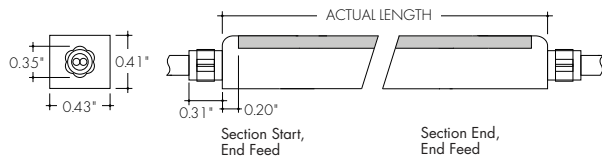

Injection Molded Side Power Feed (ISPF)

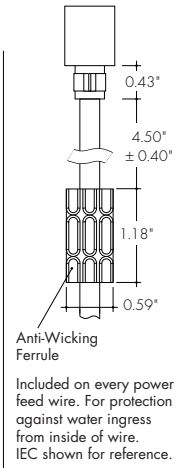
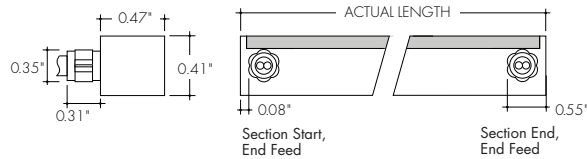

Ordering Code

MODEL	CCT	SECTION START	SECTION END	ACTUAL LENGTH
KBS-FV -Kurba Small Flat, Vertical Bend	22K-2200K 24K-2400K 27K-2700K 30K-3000K 35K-3500K 40K-4000K	IEC-Injection Molded End cap ¹ IEPF-Injection Molded End power feed (9' wire lead) ¹ IBPF-Injection Molded Bottom power feed (9' wire lead) ¹ ISPF-Injection Molded Side power feed (9' wire lead) ^{1, 2}	IEC-Injection Molded End cap ¹ IEPF-Injection Molded End power feed (9' wire lead) ¹ IBPF-Injection Molded Bottom power feed (9' wire lead) ¹ ISPF-Injection Molded Side power feed (9' wire lead) ^{1, 2}	See Power Consumption table on page 3 for available lengths

1 - 6-8 weeks lead time. Kurba injected-molded orders are non-cancellable. IEPF, IBPF, ISPF cannot be mixed and matched from Start to End except with IEC.
2 - ISPF Side power feeds selected for both Section Start and End will be located on the same side of the strip.

Mounting Accessories & Optional Connectors

MB-KBS-F-ST

Mounting Bracket with Grip

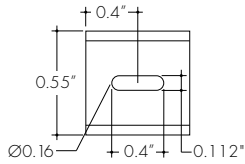
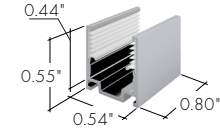

Aluminum mounting bracket providing grip. For use with light strip mounted to the ceiling. 1 recommended every 8 in.

MC-NFS-KBS-F-78

Mounting Channel with Grip, 78"

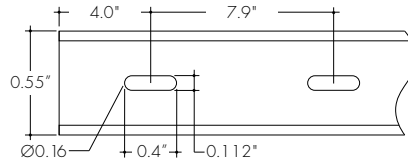
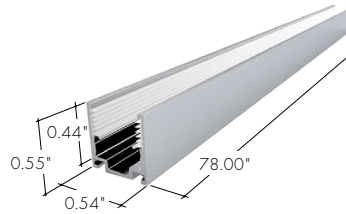

Aluminum mounting channel providing grip. For use with light strip mounted to the ceiling.

LVSP-WET

Splice Box

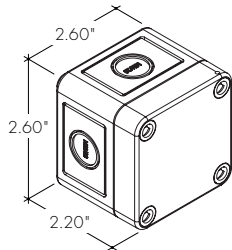

Wet rated, low voltage splice box, gray.

LVSP-WET-CM

Connector

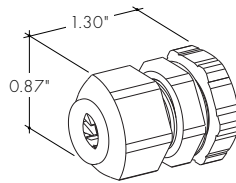

Low voltage splice box wet cable management, gray.

Power Consumption Per Fixture Length

Based on operation with PDCU series of power supplies. Use Acutal Length for Order Code Entry
 Tolerance for Actual Lengths less than 6 ft is +/- 0.2", Actual Lengths between 6 ft and 16 ft is +/- 0.3", and Actual Lengths greater than 16 ft is +/- 0.6"

Nominal Length (in)	Actual Length (in)				Nominal Length (in)	Actual Length (in)				Nominal Length (in)	Actual Length (in)				Nominal Length (in)	Actual Length (in)			
	W	IEPF IEPF	IEC IEPF	IEC IBPF ISPF		W	IEPF IEPF	IEC IEPF	IEC IBPF ISPF		W	IEPF IEPF	IEC IEPF	IEC IBPF ISPF		W	IEPF IEPF	IEC IEPF	IEC IBPF ISPF
4	-	-	-	-	112	12.8	111.9	111.8	111.7	220	25.2	220.2	220.1	220	322	36.8	321.9	321.8	321.7
7	0.8	7	6.8	6.7	115	13.2	115.2	115.1	115	223	25.6	223.5	223.4	223.2	(27 ft) 325	37.2	325.2	325.1	325
10	1.2	10.2	10.1	10	(10 ft) 118	13.5	118.5	118.4	118.3	(19 ft) 227	25.9	226.8	226.6	226.5	328	37.6	328.5	328.4	328.2
(1 ft) 14	1.5	13.5	13.4	13.3	122	13.9	121.8	121.7	121.5	230	26.3	230	229.9	229.8	332	37.9	331.8	331.6	331.5
17	1.9	16.8	16.7	16.6	125	14.3	125.1	124.9	124.8	165	50.1	164.5	164.3	164.2	(28 ft) 335	38.3	335	334.9	334.8
20	2.3	20.1	20	19.8	128	14.7	128.3	128.2	128.1	167	50.8	166.6	166.5	166.4	338	38.7	338.3	338.2	338.1
(2 ft) 23	2.7	23.4	23.2	23.1	(11 ft) 132	15	131.6	131.5	131.4	233	26.7	233.3	233.2	233.1	342	39.1	341.6	341.5	341.4
27	3	26.6	26.5	26.4	135	15.4	134.9	134.8	134.7	237	27.1	236.6	236.5	236.4	345	39.4	344.9	344.8	344.6
30	3.4	29.9	29.8	29.7	138	15.8	138.2	138.1	137.9	(20 ft) 240	27.4	239.9	239.8	239.7	(29 ft) 348	39.8	348.2	348	347.9
33	3.8	33.2	33.1	33	141	16.2	141.5	141.4	141.2	243	27.8	243.2	243.1	242.9	351	40.2	351.4	351.3	351.2
(3 ft) 36	4.2	36.5	36.4	36.2	(12 ft) 145	16.5	144.8	144.6	144.5	246	28.2	246.5	246.3	246.2	355	40.6	354.7	354.6	354.5
40	4.5	39.8	39.6	39.5	148	16.9	148	147.9	147.8	250	28.6	249.7	249.6	249.5	358	40.9	358	357.9	357.8
43	4.9	43	42.9	42.8	151	17.3	151.3	151.2	151.1	(21 ft) 253	28.9	253	252.9	252.8	(30 ft) 361	41.3	361.3	361.2	361
46	5.3	46.3	46.2	46.1	(13 ft) 155	17.7	154.6	154.5	154.4	256	29.3	256.3	256.2	256.1	Note: all values are rounded to the nearest 0.1 inch				
(4 ft) 50	5.7	49.6	49.5	49.4	158	18	157.9	157.8	157.6	260	29.7	259.6	259.5	259.3					
53	6	52.9	52.8	52.7	161	18.4	161.2	161	160.9	(22 ft) 263	30.1	262.9	262.7	262.6					
56	6.4	56.2	56.1	55.9	164	18.8	164.4	164.3	164.2	266	30.4	266.1	266	265.9					
(5 ft) 59	6.8	59.5	59.3	59.2	(14 ft) 168	19.2	167.7	167.6	167.5	269	30.8	269.4	269.3	269.2					
63	7.2	62.7	62.6	62.5	171	19.5	171	170.9	170.8	273	31.2	272.7	272.6	272.5					
66	7.5	66	65.9	65.8	174	19.9	174.3	174.2	174	(23 ft) 276	31.6	276	275.9	275.7					
69	7.9	69.3	69.2	69.1	178	20.3	177.6	177.4	177.3	279	31.9	279.3	279.1	279					
(6 ft) 73	8.3	72.6	72.5	72.3	(15 ft) 181	20.7	180.8	180.7	180.6	282	32.3	282.5	282.4	282.3					
76	8.7	75.9	75.7	75.6	184	21.1	184.1	184	183.9	286	32.7	285.8	285.7	285.6					
79	9	79.1	79	78.9	187	21.4	187.4	187.3	187.2	(24 ft) 289	33.1	289.1	289	288.9					
(7 ft) 82	9.4	82.4	82.3	82.2	(16 ft) 191	21.8	190.7	190.6	190.4	292	33.4	292.4	292.3	292.1					
86	9.8	85.7	85.6	85.5	194	22.2	194	193.8	193.7	296	33.8	295.7	295.5	295.4					
89	10.2	89	88.9	88.7	197	22.6	197.2	197.1	197	(25 ft) 299	34.2	298.9	298.8	298.7					
92	10.5	92.3	92.1	92	200	22.9	200.5	200.4	200.3	302	34.6	302.2	302.1	302					
(8 ft) 96	10.9	95.5	95.4	95.3	(17 ft) 204	23.3	203.8	203.7	203.6	305	34.9	305.5	305.4	305.3					
99	11.3	98.8	98.7	98.6	207	23.7	207.1	207	206.8	309	35.3	308.8	308.7	308.5					
102	11.7	102.1	102	101.9	210	24.1	210.4	210.2	210.1	(26 ft) 312	35.7	312.1	311.9	311.8					
105	12	105.4	105.3	105.1	214	24.4	213.6	213.5	213.4	315	36.1	315.3	315.2	315.1					
(9 ft) 109	12.4	108.7	108.5	108.4	(18 ft) 217	24.8	216.9	216.8	216.7	319	36.4	318.6	318.5	318.4					

Injection Molded End Cap (IEC)

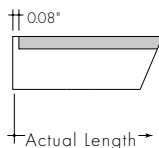

Injection Molded End Power Feed (IEPF)

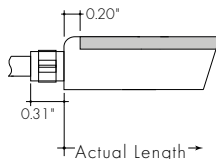

Injection Molded Bottom Power Feed (IBPF)

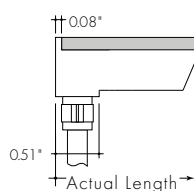

Injection Molded Side Power Feed (ISPF)

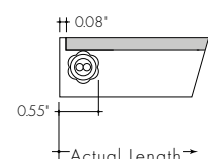

Power Supplies

See Power Supply instructions and spec sheet for wiring information. For a complete list of compatible dimmers, see Compatible Dimming Chart on the Resources page.

Universal Power Supply 1% 120VAC - 277VAC

MODEL	POWER	OUTPUT
PDCU-D - IP20 Dry Series	30 - 30 W 60 - 60 W 96 - 96 W 3X96 - 3X96 W	24 - 24 VDC
PDCU-W - IP66 Wet Series	96 - 96 W 3X96 - 3X96 W	

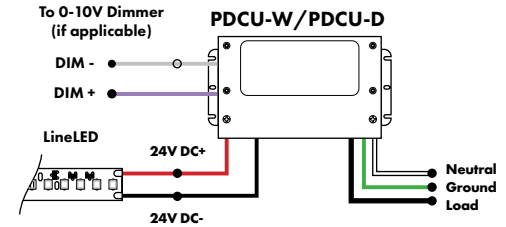

0-10V dims down to 1%, MLV/ELV/TRIAC dims down to 1%.
For a complete list of compatible dimmers, see [Compatible Dimming Chart](#) on the Resources page.

MODELS	PDCU-W 96W	PDCU-W 3X96W	PDCU-D 30W	PDCU-D 60W	PDCU-D 96W	PDCU-D 3X96W
Length	8.66"	11.85"	6.10"	7.93"	8.25"	9.57"
Width	3.73"	4.32"	3.35"	3.35"	4.10"	5.94"
Depth	1.61"	1.81"	1.33"	1.32"	1.56"	1.13"

0-10V Dimming Power Supplies 0.1% 120VAC - 277VAC

MODEL	POWER	OUTPUT	DIMMING
PS010V - 0-10V Power Supply dims down to 0.1%	96 - 96 Watt 3X96 - 3 X 96 Watt	24 - 24 VDC	LIN - Linear LOG - Logarithmic

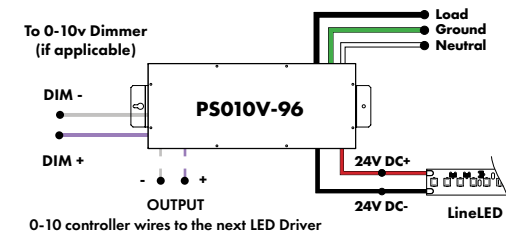

MODELS	96W	3X96
Length	14.40"	15.75"
Width	5.20"	6.62"
Depth	2.60"	4.95"

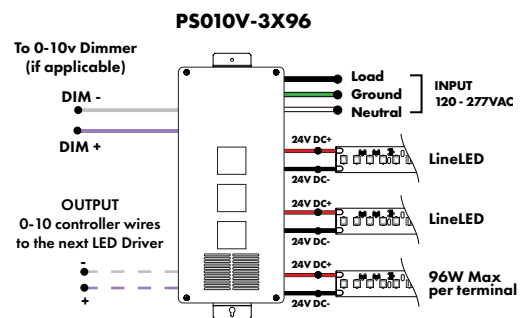

Triac, MLV, & ELV Compatible Dimmers

MODEL	POWER	OUTPUT
PDC - (IP20) Power Supply	96 - 96 Watts	24 - 24 VDC

MODELS	96W
Length	8.25"
Width	4.10"
Depth	1.56"

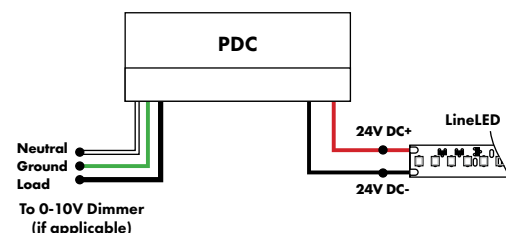

Power Supplies

See Power Supply instructions and spec sheet for wiring information. For a complete list of compatible dimmers, see Compatible Dimming Chart on the Resources page.

DMX Dimming Power Supplies 120VAC - 277VAC

MODEL	POWER	OUTPUT
PSDMX - DMX Power Supply dims down to 0%	96 - 96 Watt 3X96 - 3 X 96 Watt	24 - 24 VDC

Features eldoLED's LINEARdrive configurable dimmable drivers

MODELS	96W	3X96
Length	14.40"	15.75"
Width	5.20"	6.62"
Depth	2.60"	4.95"

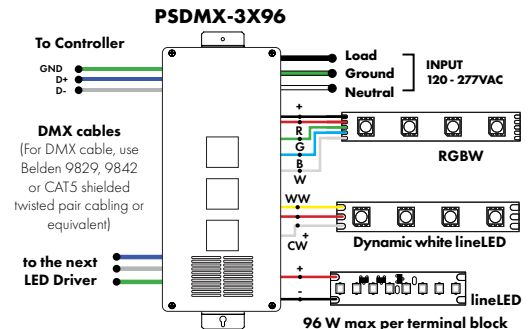
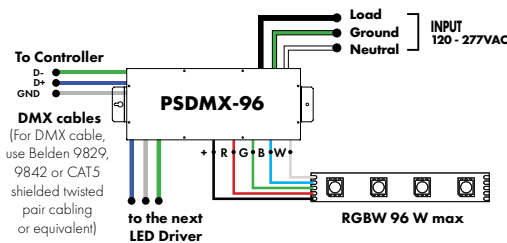

DALI 0% Dimming Power Supplies 120VAC - 277VAC

MODEL	POWER	OUTPUT
PSDALI - DALI Power Supply dims down to 0%	96 - 96 Watt 3X96 - 3 X 96 Watt	24 - 24 VDC

Features eldoLED's LINEARdrive configurable dimmable drivers

Model	96W	3X96
Length	14.40"	15.75"
Width	5.20"	6.62"
Depth	2.60"	4.95"

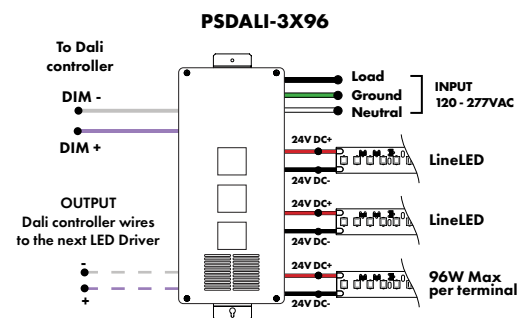
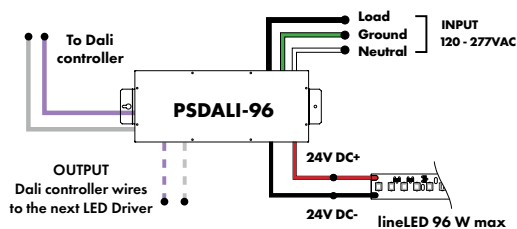

Enlighted Enabled Dimming Power Supplies 120VAC - 277VAC

MODEL	POWER	OUTPUT	DIMMING	LOCATION
PSV - PSV Series	96 - 96 Watt	24 - 24 VDC	ENL - Enlighted Dimming dims down to 0%	D - Damp

Model	96W
Length	14.40"
Width	5.20"
Depth	2.60"

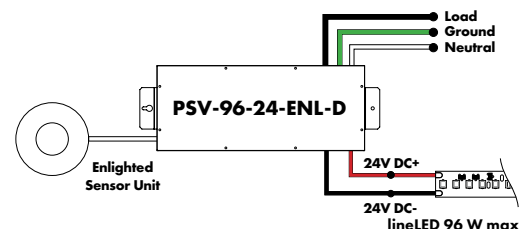

Power Supplies

See Power Supply instructions and spec sheet for wiring information. For a complete list of compatible dimmers, see Compatible Dimming Chart on the Resources page.

Non-Dimming Power Supply 120VAC - 277VAC

MODEL	POWER	OUTPUT	DIMMING	LOCATION
PSV - PSV Series	96 - 96 Watt	24 - 24 VDC	ND - Non Dimming	D - Damp

MODELS	96W
Length	14.40"
Width	5.20"
Depth	2.60"

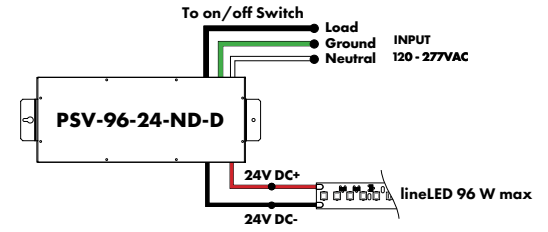

Luminii is a Lutron OEM Advantage Partner

Lutron Power Supplies 1%

MODEL
L3DA4U1UKL-CV240

HiLume™ 1% EcoSystem Voltage LED driver 40W max

MODELS	L3DA4U1UKL-CV240
Length	4.98"
Width	4.00"
Depth	2.62"

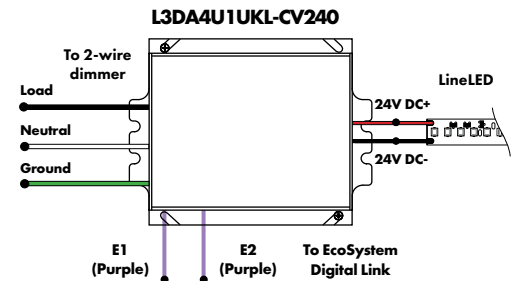

Luminii is a Lutron OEM Advantage Partner

Lutron Power Supplies 0.1%

MODEL
L3D0-96W24V-U

HiLume™ 0.1% EcoSystem Voltage LED Driver with Soft-On, Fade-to-Black™ 96W max

MODELS	L3D0
Length	10.50"
Width	5.50"
Depth	2.00"

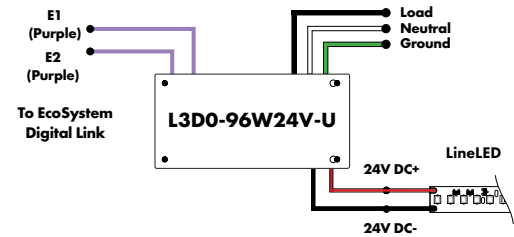

In-Ground Power Supplies

MODEL	POWER	OUTPUT	INPUT
IG - In ground CVE Series CVE - ELV Dimming DALI - eldoLED Dali dimming Both dims down to 0%	96X2 - 2 X 96 Watt	24 - 24 VDC	Blank - 120 V 277 - 240/277 V

MODELS	Dual Circuit
Length	8.40"
Width	8.30"
Depth	8.10"

