

Features

Kurba Medium Horizontal Pixel RGBW is a light strip with a sleek, direct view profile. Infinite RGBW lighting possibilities are now achievable with ease. Advanced design allows for animation effects such as cascading and chasing at the granular level. Capable of horizontal/side bends up to 2.5" radius and built with robust factory made power feeds and end caps, Kurba Medium Horizontal Pixel RGBW mounts to a specifically designed extruded aluminum channel.

Applications
Outdoor wet location

Operating Voltage
24VDC

Operating Temperature
-4°F to 113°F (-20°C to 45°C)

Average Life
50,000 hours

Average Life
50,000 hours

Approvals
Class 2 wet listed, IP67

Warranty
3 years



Technical Information

Model	KBM-F-H-SPI-RGBW30K
LEDs/ft	17
Light Output (300K)	Red: 12 lm/ft Green: 30 lm/ft Blue: 5 lm/ft White: 30 lm/ft All On: 77 lm/ft
Average Power Consumption at 4'	4.6 W/ft
Ordering Increment/Pixel Length	4.92"
Maximum Run Length (In Series)	20 ft
DMX Addresses Occupied	4 channels per pixel

Constraints

Bend Direction
Bend LED in these positions only to avoid damage

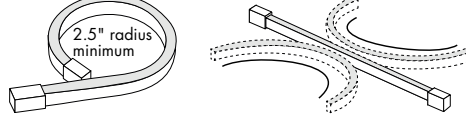

Illuminated surface shown in gray

Prohibited Bends
Twisting or bending LED in these positions will cause damage

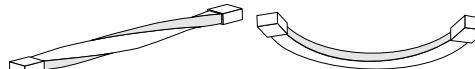

Illuminated surface shown in gray

Note: for horizontal bends refer to Luminii KBM series
Do not make sharp bends near the endcap

Power Feed Locations

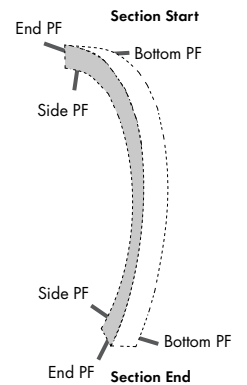

Section Start/End Power Feed Options

Injection Moulded End Cap (IEC)

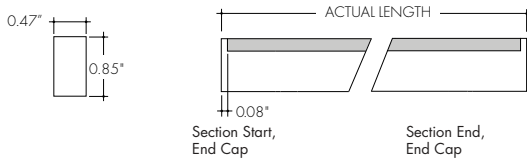

Injection Moulded Bottom Power Feed (IBPF)

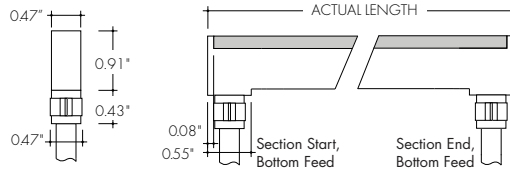

Injection Moulded End Power Feed (IEPF)

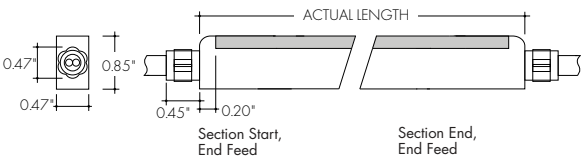

Injection Moulded Side Power Feed (ISPF)

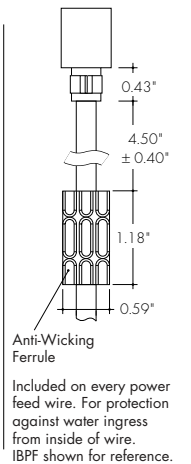
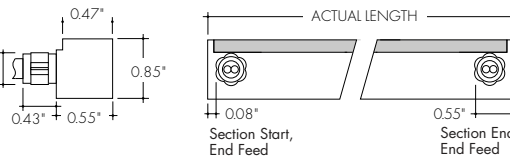

Ordering Code for Straight Run

MODEL	CCT	SECTION START	SECTION END	ACTUAL LENGTH
KBM-F-H -Kurba Medium, Flat, Horizontal/Side Bend	SPI-RGBW30K -RGBW Smart Pixel Control (3000K) SPI-RGBW40K -RGBW Smart Pixel Control (4000K)	IEC -Injection Moulding End cap ¹ IEPF -Injection Moulding End power feed (9' wire lead) ¹ IBPF -Injection Moulding Bottom power feed (9' wire lead) ¹ ISPF -Injection Moulding Side power feed (9' wire lead) ^{1,2}	IEC -Injection Moulding End cap ¹ IEPF -Injection Moulding End power feed (9' wire lead) ¹ IBPF -Injection Moulding Bottom power feed (9' wire lead) ¹ ISPF -Injection Moulding Side power feed (9' wire lead) ^{1,2}	See Power Consumption table on page 3 for available lengths.

1 - 6-8 weeks lead time. Kurba injected-molded orders are non-cancellable. IEPF, IBPF, ISPF cannot be mixed and matched from Start to End except with IEC.
2 - ISPF Side power feeds selected for both Section Start and End will be located on the same side of the strip.

Mounting Accessories & Optional Connectors

MC-NFS-KBM-F-H-78

Mounting Channel with Grip, 78"

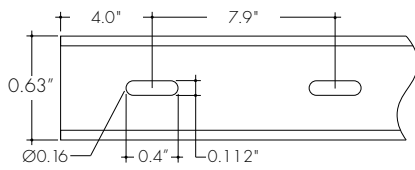
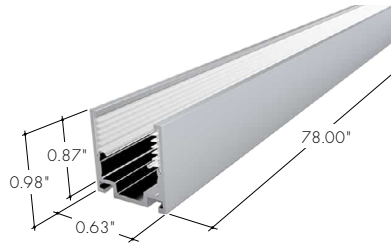

Aluminum mounting channel providing grip. For use with light strip mounted to the ceiling.

MB-KBM-F-H-ST

Mounting Bracket with Grip

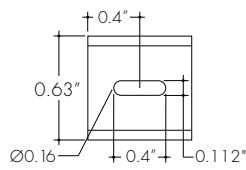
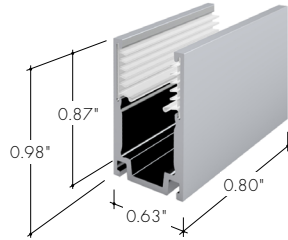

Aluminum mounting bracket providing grip. For use with light strip mounted to the ceiling. 1 recommended every 8 in.

MC-FS-KBM-F-H-78

Flanged Mounting Channel with Grip, 78"

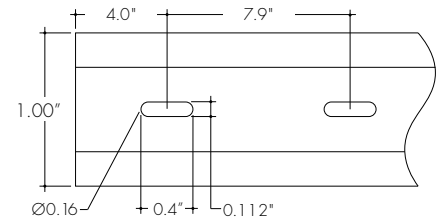
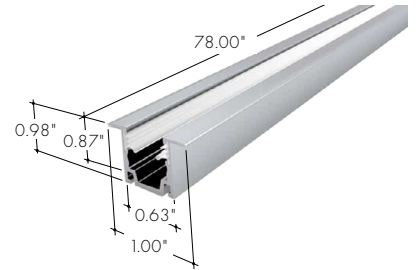

Flanged aluminum mounting channel providing grip. For use with light strip mounted to the ceiling.

MC-BS-KBM-F-H-38

Bendable Mounting Channel with Grip, 38"

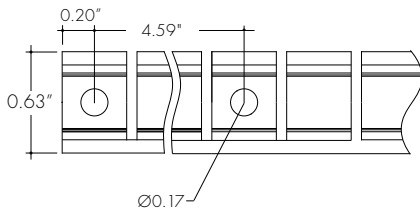
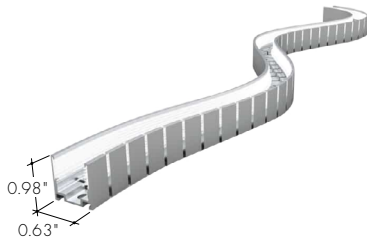

Bendable stainless steel mounting channel providing grip. For use with light strip mounted to the ceiling.

LVSP-WET-CM

Connector

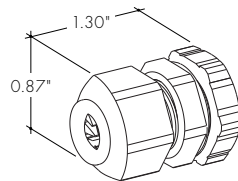

Low voltage splice box wet cable management, gray.

LVSP-WET

Splice Box

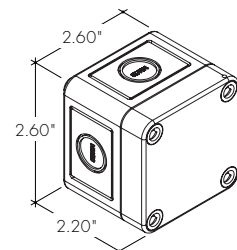

Wet rated, low voltage splice box, gray.

Power Consumption Per Fixture Length

Based on operation with PDCU series of power supplies. Use Acutal Length for Order Code Entry
 Tolerance for Actual Lengths less than 6 ft is +/- 0.2", Actual Lengths between 6 ft and 16 ft is +/- 0.3", and Actual Lengths greater than 16 ft is +/- 0.6"

Nominal Length (inch)	Actual Length [inches]				Nominal Length (inch)	Actual Length [inches]			
	W	IEPF	IEC IEPF	IEC IBPF ISPF		W	IEPF	IEC IEPF	IEC IBPF ISPF
5	-	-	-	-	(14 ft) 168	63.9	167.7	167.6	167.5
(1 ft) 10	3.9	10.2	10.1	10	173	65.8	172.6	172.5	172.4
15	5.8	15.2	15	14.9	(15 ft) 178	67.7	177.6	177.4	177.3
20	7.7	20.1	20	19.8	182	69.5	182.5	182.4	182.2
(2 ft) 25	9.5	25	24.9	24.8	187	71.4	187.4	187.3	187.2
30	11.4	29.9	29.8	29.7	(16 ft) 192	73.3	192.3	192.2	192.1
(3 ft) 35	13.3	34.8	34.7	34.6	197	75.2	197.3	197.1	197
40	15.2	39.8	39.7	39.5	(17 ft) 202	77	202.2	202.1	201.9
45	17	44.7	44.6	44.5	207	78.9	207.1	207	206.9
(4 ft) 50	18.9	49.6	49.5	49.4	212	80.8	212	211.9	211.8
55	20.8	54.5	54.4	54.3	(18 ft) 217	82.7	216.9	216.8	216.7
(5 ft) 59	22.7	59.5	59.3	59.2	222	84.5	221.9	221.7	221.6
64	24.5	64.4	64.3	64.1	(19 ft) 227	86.4	226.8	226.7	226.5
69	26.4	69.3	69.2	69.1	232	88.3	231.7	231.6	231.5
(6 ft) 74	28.3	74.2	74.1	74	237	90.2	236.6	236.5	236.4
79	30.2	79.1	79	78.9	(20 ft) 242	92.1	241.5	241.4	241.3
(7 ft) 84	32	84.1	83.9	83.8					
89	33.9	89	88.9	88.7					
(8 ft) 94	35.8	93.9	93.8	93.7					
99	37.7	98.8	98.7	98.6					
104	39.5	103.7	103.6	103.5					
(9 ft) 109	41.4	108.7	108.5	108.4					
114	43.3	113.6	113.5	113.3					
(10 ft) 119	45.2	118.5	118.4	118.3					
123	47	123.4	123.3	123.2					
128	48.9	128.4	128.2	128.1					
(11 ft) 133	50.8	133.3	133.2	133					
138	52.7	138.2	138.1	138					
(12 ft) 143	54.5	143.1	143	142.9					
148	56.4	148	147.9	147.8					
153	58.3	153	152.8	152.7					
(13 ft) 158	60.2	157.9	157.8	157.6					
163	62	162.8	162.7	162.6					

Note: all values are rounded to the nearest 0.1 inch

Injection Molded End Cap (IEC)

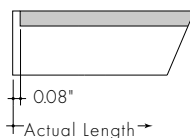

Injection Molded Bottom Power Feed (IBPF)

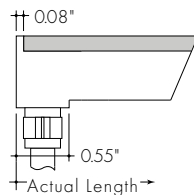

Injection Molded Side Power Feed (ISPF)

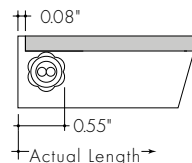

Injection Molded End Power Feed (IEPF)

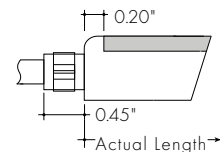

Power Supplies

See fixture and power supply instructions & spec sheet for wiring information. Dimming possible in select models - view Luminii website for list of compatible dimmers.

For use with RGB/RGBW/Pixel

Non-Dimming Power Supply 120VAC - 277VAC

MODEL	POWER	OUTPUT	DIMMING	LOCATION
PSV-PSV Series	96-96 Watt	24-24 VDC	ND-Non Dimming	D-Dry location

Requires a controller and a decoder to work properly

MODELS	96W
Length	8.25"
Width	4.10"
Depth	1.56"

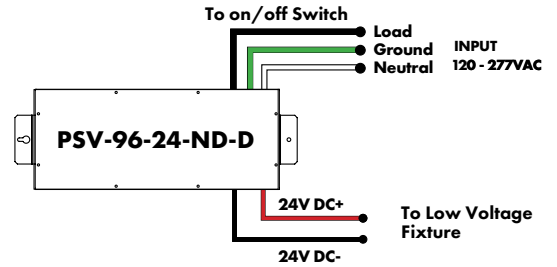

DMX-1Z-RGBW, DMX-3Z-RGBW

RGBW LED 1 or 3 Zone Controller

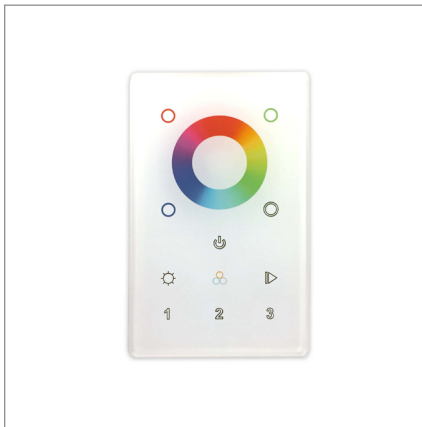

ORDERING CODE

MODEL	ZONES	COLOR
DMX - DMX Controller	3Z - Three Zone 1Z - One Zone	RGBW - Red, Green, Blue, & White

DMX /Wireless RGB-W wall-mount controller controls DMX lighting fixtures, wireless control of RGB-W lighting fixture or use both simultaneously. Fits in any standard US switch box. Includes all the outputs in the back of the controller.

Control brightness levels with a single touch, personalize and memorize 3 different scenes, and even create 3 variations of white.

Features

- 2 in 1 in-Wall Controller: DMX Control or Wireless RGB-W
- 65,000 Color Options, Dimming and Speed Control
- Memory Function
- 50 Foot Wireless Range
- Easily Fits Standard US Switch Boxes
- Touch Sensitive Glass Surface
- Includes 10 Built in Programs, or Create and Play Your Own

Operating Voltage

12 - 24V DC

Color Parameters

- Brightness
- Saturation
- Primary colors
- Fading
- Color changing speed

Touch DMX Controller

Touchscreen digital LED controller

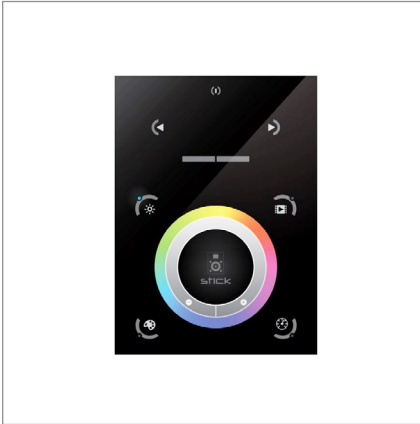

ORDERING CODE

MODEL

TSDMX-E

TSDMX-E - Touchscreen DMX controller

Programmable advanced DMX512 lighting controller featuring a touch-screen interface. Operates as stand alone controller or integrated with most architectural lighting control systems. Can controller endless DMX512 enabled devices.

Mounts to standard single or dual gang wall box with the included power supply inside the junction box. Terminal block design for power and data connections.

Features

- Sleek glass design which sits 0.43" from the wall
- Graphical color display to show selected environment
- Color/dimmer/speed palette
- Color temperature mixing
- Touch sensitive buttons. No mechanical parts
- Touch sensitive wheel allows for accurate color selection
- Multi-zone microSD memory
- Multi-room control with 500 scenes, 10 zones
- 1024 DMX channels. Control 340 RGB fixtures
- USB & Ethernet connectivity for programming and control

Power Supply

7 VDC (included)

Programmability

PC, Mac, Tablet, Smartphone

Output Signal

DMX512 (1024 channels)

Color Parameters

- Brightness
- Saturation
- Speed of color changing sequence
- Fading / dimming / brightness

Smart Pixel Decoder

SPI signal to DMX signal decoder



ORDERING CODE

MODEL

SR-DMX-SPI

SR-DMX-SPI - Smart Pixel Decoder

The SR-DMX-SPI is a smart LED pixel decoder that controls RGB/RGBW pixel LED strips with SPI signal. Designed with an OLED backlit panel, the pixel controller allows for easy configuration of most settings. Four push buttons are available for control of the LED functions.

*For pixel only.

Features

- 2 in 1 in-Wall Controller: DMX Control or Wireless RGB-W
- SPI signal output for RGB/RGBW pixel light control
- DMX512 controllable and RF/WIFI remote controllable
- Capable of addressing up to 1020 RGB pixels & 765 RGB pixels
- OLED panel allows for easy configuration

Operating Voltage

12 - 36V DC

Power capacity

up to 96W at 24V

Operating temperature range

from -4°F to +122°F in case