

Features

Kurba Medium Dome Horizontal Dynamic White is a direct view, energy efficient and flexible LED strip suitable for wet locations capable of horizontal/side bends up to 2.5" radius. Built with robust factory made power feeds or joiners, Kurba Medium Dome Horizontal Dynamic White mounts to a specifically designed aluminum extruded channel.

Applications

Outdoor wet location

Operating Voltage

24VDC

Operating Temperature

-4°F to 113°F (-20°C to 45°C)

Average Life

50,000 hours

Dimming

Low voltage dimmer and class 2 dimming power supply required

Approvals

Class 2 wet listed, IP67

Warranty

3 years



Warm Dimming

Dynamic White

Wet Rated IP67

Technical Information

| Model | KBM-D-H-DW | | |
|---------------------------------|------------|----------|----------|
| LEDs/ft | 44 | | |
| Light Output | 19K: | 27K: | All On: |
| | 40 lm/ft | 40 lm/ft | 80 lm/ft |
| Average Power Consumption at 4' | 3.7 W/ft | | |
| Ordering Increment | 3.28" | | |
| Maximum Run Length (In Series) | 25" | | |

Constraints

Bend Direction

Bend LED in these positions only to avoid damage

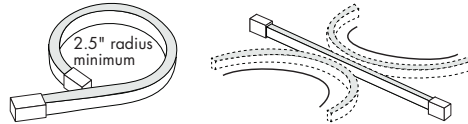

Illuminated surface shown in gray

Prohibited Bends

Twisting or bending LED in these positions will cause damage

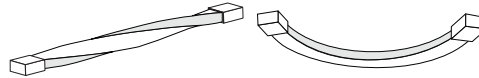

Illuminated surface shown in gray

Note: for horizontal bends refer to Luminii KBM series
Do not make sharp bends near the endcap

Power Feed Locations

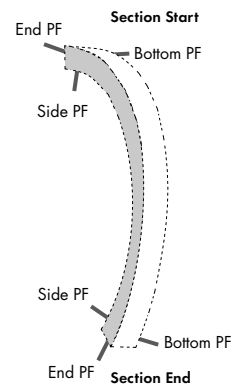

Section Start/End Power Feed Options

Injection Molded End Cap (IEC)

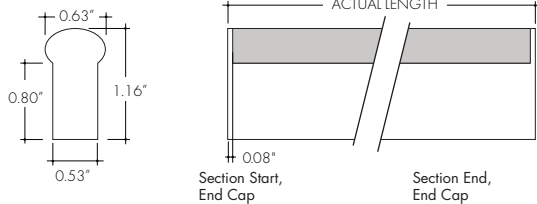

Injection Molded Bottom Power Feed (IBPF)

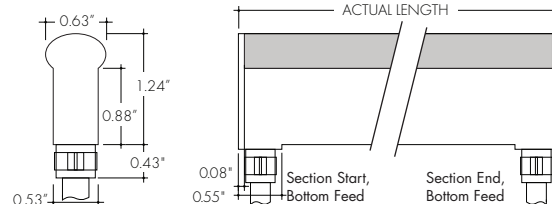

Injection Molded End Power Feed (IEPF)

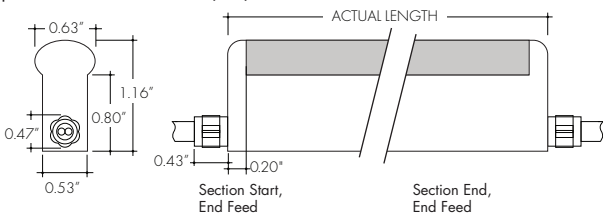

Injection Molded Side Power Feed (ISPF)

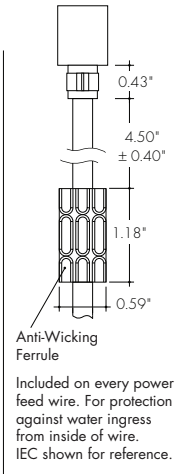
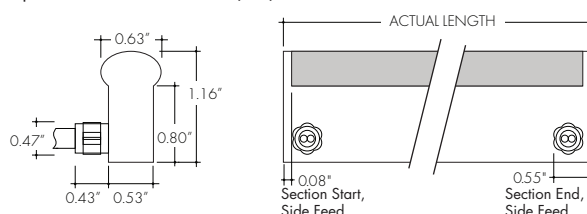

Ordering Code

| MODEL | CCT | SECTION START | SECTION END | ACTUAL LENGTH |
|--|------------------------------|--|--|--|
| KBM-D-H - Kurba Medium, Domed, Horizontal /Side Bend | DW-Dynamic White 1900K-2700K | IEC-Injection Molded End cap ¹ IEPF-Injection Molded End power feed (9' wire lead) ¹ IBPF-Injection Molded Bottom power feed (9' wire lead) ¹ ISPF-Injection Molded Side power feed (9' wire lead) ^{1, 2} | IEC-Injection Molded End cap ¹ IEPF-Injection Molded End power feed (9' wire lead) ¹ IBPF-Injection Molded Bottom power feed (9' wire lead) ¹ ISPF-Injection Molded Side power feed (9' wire lead) ^{1, 2} | See Power Consumption table on page 3 for available lengths. |

1 - 6-8 weeks lead time. Kurba injected-molded orders are non-cancellable. IEPF, IBPF, ISPF cannot be mixed and matched from Start to End except with IEC.
2 - ISPF Side power feeds selected for both Section Start and End will be located on the same side of the strip.

Mounting Accessories & Optional Connectors

MB-KBM-F-H-ST

Mounting Bracket with Grip

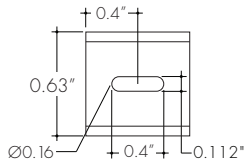
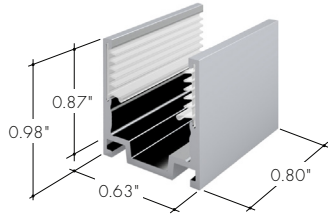

Aluminum mounting bracket providing grip. For use with light strip mounted to the ceiling. 1 recommended every 8 in.

MC-NFS-KBM-F-H-78

Mounting Channel with Grip, 78"

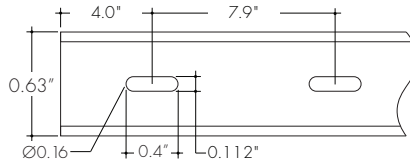
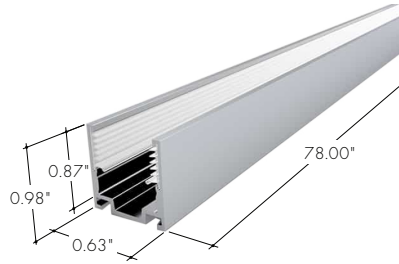

Aluminum mounting channel providing grip. For use with light strip mounted to the ceiling.

MC-FS-KBM-F-H-78

Flanged Mounting Channel with Grip, 78"

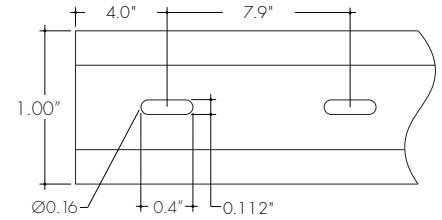
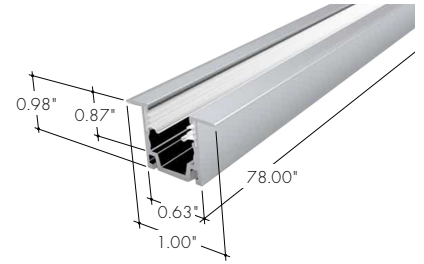

Flanged aluminum mounting channel providing grip. For use with light strip mounted to the ceiling.

MC-BS-KBM-F-H-38

Bendable Mounting Channel with Grip, 38"

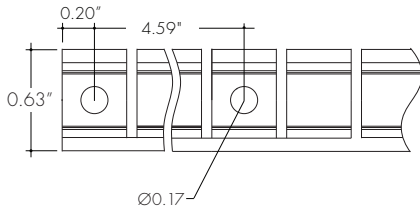
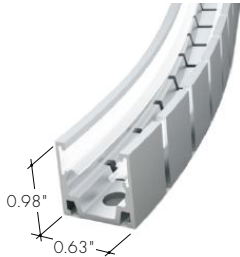

Bendable aluminum mounting channel providing grip. For use with light strip mounted to the ceiling.

LVSP-WET

Splice Box

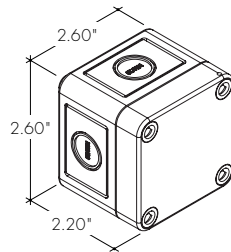

Wet rated, low voltage splice box, gray.

LVSP-WET-CM

Connector

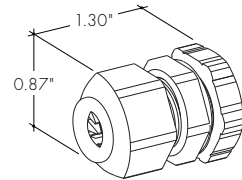

Low voltage splice box wet cable management, gray.

Power Consumption Per Fixture Length

Based on operation with PDCU series of power supplies. Use Acutal Length for Order Code Entry
 Tolerance for Actual Lengths less than 6 ft is +/- 0.2", Actual Lengths between 6 ft and 16 ft is +/- 0.3", and Actual Lengths greater than 16 ft is +/- 0.6"

| Nominal Length (inch) | Actual Length (in) | | | | Nominal Length (inch) | Actual Length (in) | | | | Nominal Length (inch) | Actual Length (in) | | | |
|-----------------------|--------------------|--------------|--------------|---------------|-----------------------|--------------------|--------------|--------------|---------------|-----------------------|--------------------|--------------|--------------|---------------|
| | W | IEPF IEPF | IEC IEPF | IEC IBPF ISPF | | W | IEPF IEPF | IEC IEPF | IEC IBPF ISPF | | W | IEPF IEPF | IEC IEPF | IEC IBPF ISPF |
| 4 | - | - | - | - | 112 | 34.1 | 111.9 | 111.8 | 111.7 | 220 | 67.1 | 220.2 | 220.1 | 220 |
| 7 | 2.1 | 7 | 6.8 | 6.7 | 115 | 35.1 | 115.2 | 115.1 | 115 | 223 | 68.1 | 223.5 | 223.4 | 223.2 |
| 10 | 3.1 | 10.2 | 10.1 | 10 | (10 ft) 118 | 36.1 | 118.5 | 118.4 | 118.3 | (19 ft) 227 | 69.1 | 226.8 | 226.6 | 226.5 |
| (1 ft) 14 | 4.1 | 13.5 | 13.4 | 13.3 | 122 | 37.1 | 121.8 | 121.7 | 121.5 | 230 | 70.1 | 230 | 229.9 | 229.8 |
| 17 | 5.1 | 16.8 | 16.7 | 16.6 | 125 | 38.1 | 125.1 | 124.9 | 124.8 | 233 | 71.1 | 233.3 | 233.2 | 233.1 |
| 20 | 6.1 | 20.1 | 20 | 19.8 | 128 | 39.1 | 128.3 | 128.2 | 128.1 | 237 | 72.1 | 236.6 | 236.5 | 236.4 |
| (2 ft) 23 | 7.1 | 23.4 | 23.2 | 23.1 | (11 ft) 132 | 40.1 | 131.6 | 131.5 | 131.4 | (20 ft) 240 | 73.1 | 239.9 | 239.8 | 239.7 |
| 27 | 8.1 | 26.6 | 26.5 | 26.4 | 135 | 41.1 | 134.9 | 134.8 | 134.7 | 243 | 74.1 | 243.2 | 243.1 | 242.9 |
| 30 | 9.1 | 29.9 | 29.8 | 29.7 | 138 | 42.1 | 138.2 | 138.1 | 137.9 | 246 | 75.1 | 246.5 | 246.3 | 246.2 |
| 33 | 10.1 | 33.2 | 33.1 | 33 | 141 | 43.1 | 141.5 | 141.4 | 141.2 | 250 | 76.1 | 249.7 | 249.6 | 249.5 |
| (3 ft) 36 | 11.1 | 36.5 | 36.4 | 36.2 | (12 ft) 145 | 44.1 | 144.8 | 144.6 | 144.5 | (21 ft) 253 | 77.1 | 253 | 252.9 | 252.8 |
| 40 | 12.1 | 39.8 | 39.6 | 39.5 | 148 | 45.1 | 148 | 147.9 | 147.8 | 256 | 78.1 | 256.3 | 256.2 | 256.1 |
| 43 | 13.1 | 43 | 42.9 | 42.8 | 151 | 46.1 | 151.3 | 151.2 | 151.1 | 260 | 79.1 | 259.6 | 259.5 | 259.3 |
| 46 | 14.1 | 46.3 | 46.2 | 46.1 | (13 ft) 155 | 47.1 | 154.6 | 154.5 | 154.4 | (22 ft) 263 | 80.1 | 262.9 | 262.7 | 262.6 |
| (4 ft) 50 | 15.1 | 49.6 | 49.5 | 49.4 | 158 | 48.1 | 157.9 | 157.8 | 157.6 | 266 | 81.1 | 266.1 | 266 | 265.9 |
| 53 | 16.1 | 52.9 | 52.8 | 52.7 | 161 | 49.1 | 161.2 | 161 | 160.9 | 269 | 82.1 | 269.4 | 269.3 | 269.2 |
| 56 | 17.1 | 56.2 | 56.1 | 55.9 | 164 | 50.1 | 164.4 | 164.3 | 164.2 | 273 | 83.1 | 272.7 | 272.6 | 272.5 |
| (5 ft) 59 | 18.1 | 59.5 | 59.3 | 59.2 | (14 ft) 168 | 51.1 | 167.7 | 167.6 | 167.5 | (23 ft) 276 | 84.1 | 276 | 275.9 | 275.7 |
| 63 | 19.1 | 62.7 | 62.6 | 62.5 | 171 | 52.1 | 171 | 170.9 | 170.8 | 279 | 85.1 | 279.3 | 279.1 | 279 |
| 66 | 20.1 | 66 | 65.9 | 65.8 | 174 | 53.1 | 174.3 | 174.2 | 174 | 282 | 86.1 | 282.5 | 282.4 | 282.3 |
| 69 | 21.1 | 69.3 | 69.2 | 69.1 | 178 | 54.1 | 177.6 | 177.4 | 177.3 | 286 | 87.1 | 285.8 | 285.7 | 285.6 |
| (6 ft) 73 | 22.1 | 72.6 | 72.5 | 72.3 | (15 ft) 181 | 55.1 | 180.8 | 180.7 | 180.6 | (24 ft) 289 | 88.1 | 289.1 | 289 | 288.9 |
| 76 | 23.1 | 75.9 | 75.7 | 75.6 | 184 | 56.1 | 184.1 | 184 | 183.9 | 292 | 89.1 | 292.4 | 292.3 | 292.1 |
| 79 | 24.1 | 79.1 | 79 | 78.9 | 187 | 57.1 | 187.4 | 187.3 | 187.2 | 296 | 90.1 | 295.7 | 295.5 | 295.4 |
| (7 ft) 82 | 25.1 | 82.4 | 82.3 | 82.2 | (16 ft) 191 | 58.1 | 190.7 | 190.6 | 190.4 | (25 ft) 299 | 91.1 | 298.9 | 298.8 | 298.7 |
| 86 | 26.1 | 85.7 | 85.6 | 85.5 | 194 | 59.1 | 194 | 193.8 | 193.7 | | | | | |
| 89 | 27.1 | 89 | 88.9 | 88.7 | 197 | 60.1 | 197.2 | 197.1 | 197 | | | | | |
| 92 | 28.1 | 92.3 | 92.1 | 92 | 200 | 61.1 | 200.5 | 200.4 | 200.3 | | | | | |
| (8 ft) 96 | 29.1 | 95.5 | 95.4 | 95.3 | (17 ft) 204 | 62.1 | 203.8 | 203.7 | 203.6 | | | | | |
| 99 | 30.1 | 98.8 | 98.7 | 98.6 | 207 | 63.1 | 207.1 | 207 | 206.8 | | | | | |
| 102 | 31.1 | 102.1 | 102 | 101.9 | 210 | 64.1 | 210.4 | 210.2 | 210.1 | | | | | |
| 105 | 32.1 | 105.4 | 105.3 | 105.1 | 214 | 65.1 | 213.6 | 213.5 | 213.4 | | | | | |
| (9 ft) 109 | 33.1 | 108.7 | 108.5 | 108.4 | (18 ft) 217 | 66.1 | 216.9 | 216.8 | 216.7 | | | | | |

Note: all values are rounded to the nearest 0.1 inch

Injection Molded End Cap (IEC)

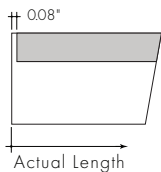

Injection Molded End Power Feed (IEPF)

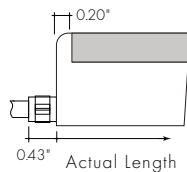

Injection Molded Bottom Power Feed (IBPF)

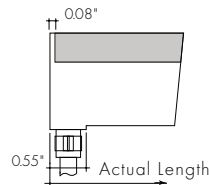

Injection Molded Side Power Feed (ISPF)

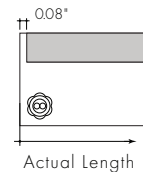

Power Supplies

See fixture and power supply instructions & spec sheet for wiring information. Dimming possible in select models - view Luminii website for list of compatible dimmers.

Triac, MLV, ELV, & PWM Compatible Dimmers

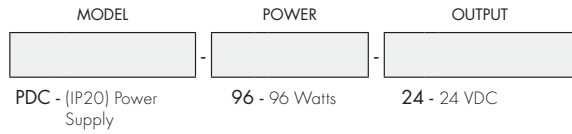

| MODELS | 96W |
|--------|-------|
| Length | 8.25" |
| Width | 4.10" |
| Depth | 1.56" |

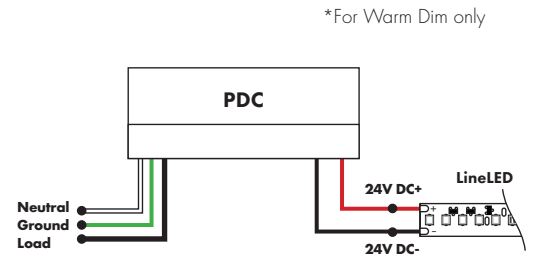

DALI 0% Dimming Power Supplies 120VAC - 277VAC



Features eldoLED's LINEARdrive configurable dimmable drivers

| Model | 96W |
|--------|--------|
| Length | 14.40" |
| Width | 5.20" |
| Depth | 2.60" |

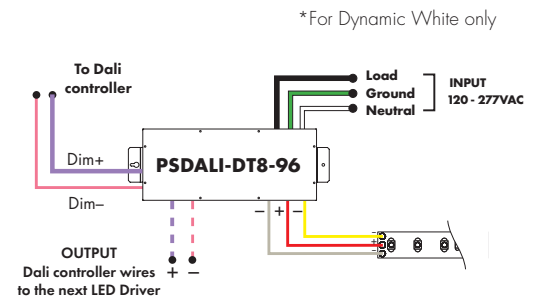

Customizable Dim to Warm or Variable White via 0 - 10V (for tunable white or warm dimming control of Dynamic option)

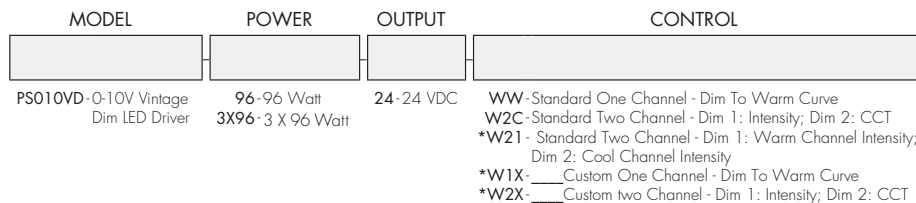

| MODELS | 96W | 3X96 |
|--------|--------|--------|
| Length | 14.40" | 15.00" |
| Width | 5.20" | 6.61" |
| Depth | 2.60" | 4.56" |

Requires a 0-10V controller to work properly
*For 96 only, not an option for 3X96.

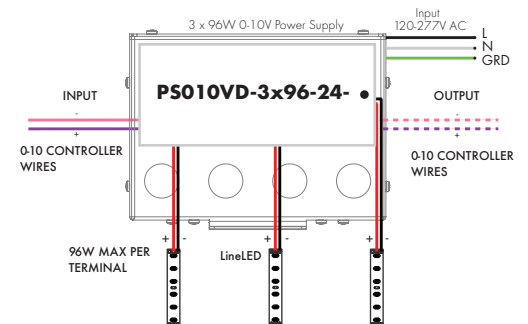
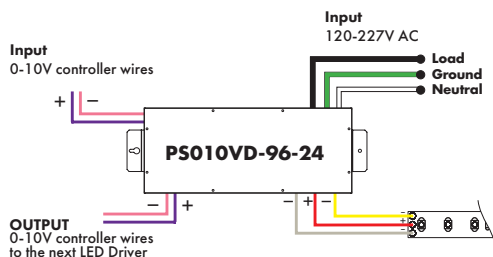

Power Supplies

See fixture and power supply instructions & spec sheet for wiring information. Dimming possible in select models - view Luminii website for list of compatible dimmers.

DMX Dimming Power Supplies 120VAC - 277VAC

*For RGB and RGBW only

| MODEL | POWER | OUTPUT |
|---|------------------------------------|-------------|
| PSDMX - DMX Power Supply dims down to 0% | 96 - 96 Watt 3X96 - 3 X 96 Watt | 24 - 24 VDC |

| MODELS | 96W | 3X96 |
|---------------|--------|--------|
| Length | 14.40" | 15.75" |
| Width | 5.20" | 6.62" |
| Depth | 2.60" | 4.95" |

Features eldoLED's LINEARdrive configurable dimmable drivers

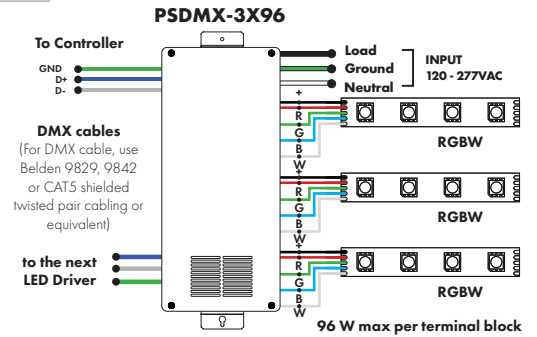
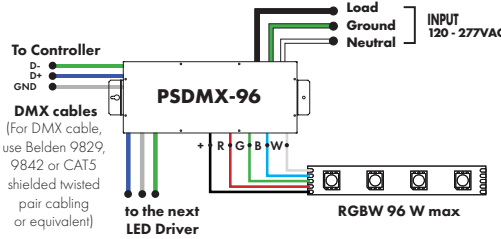

Non-Dimming Power Supply 120VAC - 277VAC

*For Dynamic White, RGB, RGBW and Pixel

*With controller only

| MODEL | POWER | OUTPUT | DIMMING | LOCATION |
|------------------|--------------|-------------|--------------------|------------------|
| PSV - PSV Series | 96 - 96 Watt | 24 - 24 VDC | U2ND - Non Dimming | D - Dry location |

Requires a controller and a decoder to work properly

| MODELS | 96W |
|-----------------|--------|
| A Length | 14.40" |
| B Width | 5.20" |
| Depth | 2.60" |

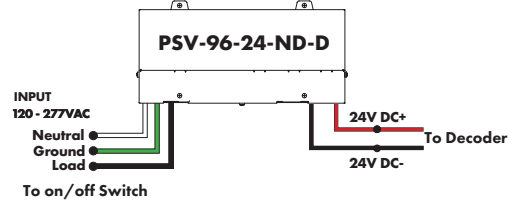

DMX Decoder

DMX signal to RGBW decoder (required to operate DMX controller)



Translates controller DMX512 programs for RGB and white LED strips.

Unique DMX address for the decoder can be set easily and displayed by the numeric display on the case. Changing and resetting the DMX address requires manual input.

Use power repeater to expand output.

Operating Voltage

12-36 VDC

Operating Temperature Range

from -4°F to +122°F in case

Power Capacity

up to 96W at 24V

ORDERING CODE

MODEL

DDMX-RGBW

DDMX-RGBW - DMX decoder

Touch DMX Controller

Touchscreen digital LED controller



MODEL

TSDMX-E

TSDMX-E - Touchscreen DMX controller

Programmable advanced DMX512 lighting controller featuring a touch-screen interface. Operates as stand alone controller or integrated with most architectural lighting control systems. Can controller endless DMX512 enabled devices.

Mounts to standard single or dual gang wall box with the included power supply inside the junction box. Terminal block design for power and data connections.

Features

- Sleek glass design which sits 0.43" from the wall
- Graphical color display to show selected environment
- Color/dimmer/speed palette
- Color temperature mixing
- Touch sensitive buttons. No mechanical parts
- Touch sensitive wheel allows for accurate color selection
- Multi-zone microSD memory
- Multi-room control with 500 scenes, 10 zones
- 1024 DMX channels. Control 340 RGB fixtures
- USB & Ethernet connectivity for programming and control

Power Supply

7 VDC (included)

Programmability

PC, Mac, Tablet, Smartphone

Output Signal

DMX512 (1024 channels)

Color Parameters

- Brightness
- Saturation
- Speed of color changing sequence
- Fading / dimming / brightness

DMX-1Z-RGBW, DMX-3Z-RGBW

RGBW LED 1 or 3 Zone Controller



MODEL

ZONES

COLOR



DMX-DMX Controller 3Z-Three Zone RGBW-RGBW
1Z-One Zone

DMX /Wireless RGB-W wall-mount controller controls DMX lighting fixtures, wireless control of RGB-W lighting fixture or use both simultaneously. Fits in any standard US switch box. Includes all the outputs in the back of the controller.

Control brightness levels with a single touch, personalize and memorize 3 different scenes, and even create 3 variations of white.

Features

- 2 in 1 in-Wall Controller: DMX Control or Wireless RGB-W
- 65,000 Color Options, Dimming and Speed Control
- Memory Function
- 50 Foot Wireless Range
- Easily Fits Standard US Switch Boxes
- Touch Sensitive Glass Surface
- Includes 10 Built in Programs, or Create and Play Your Own

Operating Voltage

12 - 24V DC

Color Parameters

- Brightness
- Saturation
- Primary colors
- Fading
- Color changing speed

Smart Pixel Decoder

SPI signal to DMX signal decoder



Model

SR-DMX-SPI

SR-DMX-SPI - Smart Pixel Decoder

The SR-DMX-SPI is a smart LED pixel decoder that controls RGB/RGBW pixel LED strips with SPI signal. Designed with an OLED backlit panel, the pixel controller allows for easy configuration of most settings. Four push buttons are available for control of the LED functions.

*For pixel only.

Features

- 2 in 1 in-Wall Controller: DMX Control or Wireless RGB-W
- SPI signal output for RGB/RGBW pixel light control
- DMX512 controllable and RF/WIFI remote controllable
- Capable of addressing up to 1020 RGB pixels & 765 RGB pixels
- OLED panel allows for easy configuration

Operating Voltage

12 - 36V DC

Power capacity

up to 96W at 24V

Operating temperature range

from -4°F to +122°F in case